



**BRADFORD  
& HOWLEY**  
HARPENDEN | MARSHALSWICK | ST ALBANS

Paddock Wood, Harpenden, AL5 1JU  
Asking Price £829,950

Offered to the market with the benefit of NO UPPER CHAIN, this three-bedroom detached bungalow occupies a GENEROUS PLOT within a peaceful residential location in the popular Southdown area of Harpenden.

The property is in good order and offers well balanced accommodation. It has been well cared for so does not require major work but does have excellent potential for future enhancement.

A particular feature of the home is the presence of mature front and rear gardens, creating an established and private outdoor setting with plenty of space for relaxation, gardening and outdoor dining. The gardens add greatly to the overall sense of tranquillity and privacy.

The bungalow presents an exciting opportunity for buyers seeking a property they can adapt to their own requirements, with clear scope to extend or redevelop, subject to the necessary planning permissions. The generous plot and established setting offer significant long-term potential.

Further practical benefits include a garage and car port, providing useful parking and storage solutions within this desirable residential area.

The location is especially appealing, with the property within easy walking distance of the popular Southdown shops, offering a range of everyday amenities, cafés and services.

Harpenden town centre and the mainline station are also easily accessible, providing excellent convenience for commuters and those wishing to enjoy the wider amenities of the town.

In addition, the bungalow is well positioned for access to highly regarded local schools, further enhancing its appeal for families and downsizers alike.

Overall, this is a rare opportunity to acquire a well-located bungalow with mature gardens, future potential and a highly desirable Southdown setting.

**Tenure: Freehold**  
**Council Tax Band: F**  
**EPC Rating: D**









### Ground Floor

Approx. 101.3 sq. metres (1090.1 sq. feet)

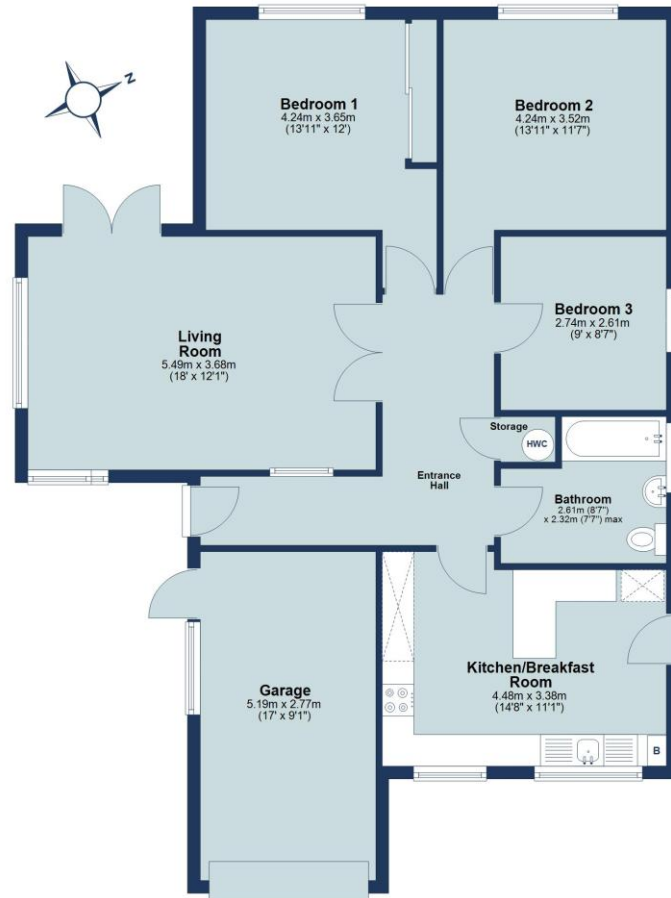

Total area: approx. 101.3 sq. metres (1090.1 sq. feet)

Floor plan is for marketing purposes only and is to be used as a guide.  
Plan produced using PlanUp.

IMPORTANT NOTICE: These particulars are for guidance only. Whilst every effort has been made to ensure the accuracy of the descriptions, plans, and measurements, these are not guaranteed, and they do not form part of any contract or tenancy. We have not tested any of the services, equipment, or fittings. No person in this firm's employment has the authority to make or give any representation or warranty in respect of the property. Interested parties should satisfy themselves as to the conditions of any such items considered material to their prospective purchase or tenancy and may wish to consult an independent advisor. It should not be assumed that any of the articles depicted in these particulars are included in the purchase or tenancy. You may download, store, and use the material for your personal use. You may not republish the material in any format without the consent of Bradford & Howley.

Looking to Sell or Let your current home?



Scan me to request your FREE Instant Online Valuation!

**Fresh**  
FINANCIAL



Sign up for FREE mortgage monitoring today, giving you peace of mind you are on the right deal, every month.

We will compare your mortgage against thousands of deals and send you a monthly report.

Please note that mortgage monitoring does not constitute mortgage advice.

**BRADFORD & HOWLEY**  
HARPENDEN | MARSHALSWICK | ST ALBANS

**f** @bradfordandhowley  
**ig** @bradfordandhowley  
**in** @bradford-howley  
**yt** @bradfordhowley4660

**tel** 01582 769966  
**em** harpenden@bradfordandhowley.com  
**loc** 42 High Street, Harpenden, Herts, AL5 2SX