



**BRADFORD
& HOWLEY**
HARPENDEN | MARSHALSWICK | ST ALBANS

Greenway, Harpenden, AL5 1NQ
Guide Price £1,400,000

This impressive four-bedroom detached family home offers spacious and beautifully presented accommodation, thoughtfully designed to suit modern lifestyles while providing excellent flexibility for family living and entertaining.

At the heart of the property is the stunning open plan kitchen and dining area, creating a bright and sociable environment ideal for both everyday use and hosting guests. This beautifully designed space benefits from large bi-fold doors which open directly onto the rear garden, allowing natural light to flood the room and creating a seamless connection between indoor and outdoor living.

The garden itself is particularly well maintained, providing an attractive setting for relaxation, entertaining and family activities. A patio area offers an ideal spot for outdoor dining, while the lawned sections enhance the overall sense of space and privacy.

To the rear of the garden, a separate garden room provides valuable additional versatility and could be used as a studio, gym, hobby room or further workspace depending on individual requirements.

The property also benefits from a spacious living room, offering a more formal and comfortable setting away from the main family area, perfect for quieter evenings or entertaining.

Upstairs, the home continues to impress with four well-proportioned bedrooms, all thoughtfully arranged and finished to a high standard. Two of the bedrooms enjoy the benefit of en-suite facilities, while a stylish family bathroom serves the remaining accommodation, ensuring convenience for busy households.

Further practicality is provided by a separate utility room and cloakroom, helping to keep the main living spaces organised and functional. In addition, a dedicated home office offers an ideal environment for remote working or study.

The location is particularly appealing for families, with the property positioned close to sought-after local schooling, while the town centre and mainline train station remain conveniently accessible for commuters and day-to-day amenities.

Overall, this is a beautifully balanced and versatile family home offering stylish interiors, excellent living space and an attractive garden setting.

Tenure: Freehold
Council Tax Band: F
EPC Rating: C









Looking to Sell or Let your current home?



Scan me to request your FREE Instant Online Valuation!



Sign up for FREE mortgage monitoring today, giving you peace of mind you are on the right deal, every month.

We will compare your mortgage against thousands of deals and send you a monthly report.

Please note that mortgage monitoring does not constitute mortgage advice.

Ground Floor
Approx. 91.8 sq. metres (987.9 sq. feet)
(excluding Garden Room)



First Floor
Approx. 77.9 sq. metres (838.4 sq. feet)

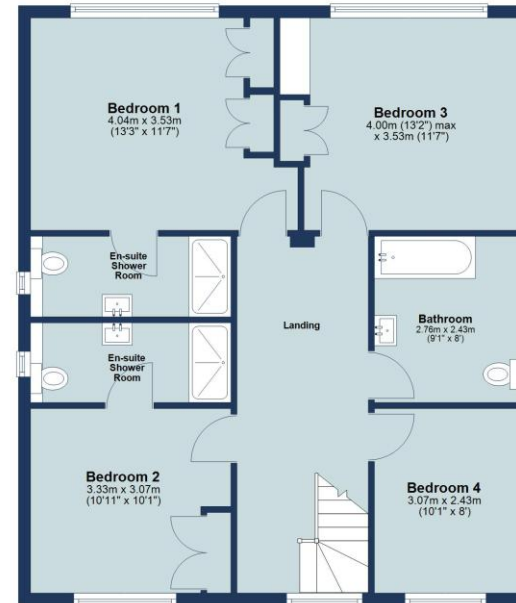

Total area: approx. 169.7 sq. metres (1826.3 sq. feet)

Floor plan is for marketing purposes only and is to be used as a guide.
Garden Room is not included in the total floor area.
Plan produced using PlanUp.

IMPORTANT NOTICE: These particulars are for guidance only. Whilst every effort has been made to ensure the accuracy of the descriptions, plans, and measurements, these are not guaranteed, and they do not form part of any contract or tenancy. We have not tested any of the services, equipment, or fittings. No person in this firm's employment has the authority to make or give any representation or warranty in respect of the property. Interested parties should satisfy themselves as to the conditions of any such items considered material to their prospective purchase or tenancy and may wish to consult an independent advisor. It should not be assumed that any of the articles depicted in these particulars are included in the purchase or tenancy. You may download, store, and use the material for your personal use. You may not republish the material in any format without the consent of Bradford & Howley.



HARPENDEN | MARSHALSWICK | ST ALBANS

- @bradfordandhowley
- @bradfordandhowley
- @bradford-howley
- @bradfordhowley4660

- 01582 769966
- harpenden@bradfordandhowley.com
- 42 High Street, Harpenden, Herts, AL5 2SX