





Property Description

Modern 2 Bedroom Coach House Apartment With Parking.

A well maintained two bedroom coach house apartment with allocated parking and a private low maintenance garden, located on a popular residential development close to Bodmin College and local leisure centre.

Externally, the property benefits from an allocated parking space and a private garden which is designed to be low maintenance. The development is conveniently positioned for access to Bodmin town centre, Bodmin College and the local leisure centre, with good road links to the A30.

The property is accessed via a private entrance with stairs leading to the first floor. The hallway leads into an open plan lounge and kitchen area. The kitchen is fitted with a gas hob and electric oven and has space for a washing machine and fridge. There is one double bedroom (with small storage cupboard), one single bedroom, and a bathroom fitted with an electric shower over the bath.

The apartment has gas central heating throughout.

Energy Rating C (73). Council Tax Band A. Deposit £1,030. Sorry, no smokers, pets or sharers.

Floorplan

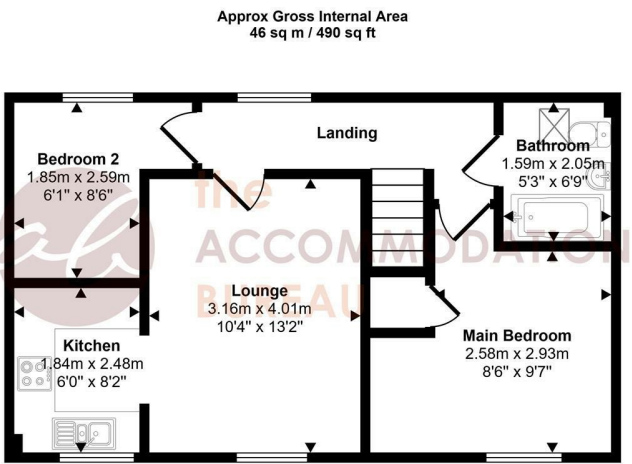

First Floor

This floorplan is only for illustrative purposes and is not to scale. Measurements of rooms, doors, windows, and any items are approximate and no responsibility is taken for any error, omission or mis-statement. Icons of items such as bathroom suites are representations only and may not look like the real items. Made with Made Snappy 360.

Location



Features

- Coach House Apartment
- Kitchen With Oven & Hob
- Bathroom With Shower
- Gas Central Heating
- Allocated Parking Space
- Close To Bodmin College
- Council Tax Band A
- Energy Rating C

Letting Information

- Rent: £895 Per Calendar Month
- Holding Deposit: £100
- Total Deposit Required: £1,030
- Local Authority: Cornwall Council
- Council Tax Band: A
- Furnishing: Unfurnished
- Available From: 16th March 2026

Energy Efficiency Rating

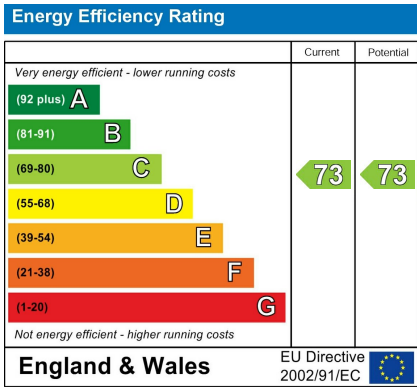

For further information, please call The Accommodation Bureau on 01208 78480.
7 Turf Street, Bodmin, PL31 2DJ. bodmin@theaccommodationbureau.com.

These particulars, whilst believed to be accurate are set out as a general outline only for guidance and do not constitute any part of an offer or contract. Prospective tenants should not rely on them as statements of representation of fact, but must satisfy themselves by inspection or otherwise as to their accuracy. No person in this firms employment has the authority to make or give any representation or warranty in respect of the property.

