



£925 Per Calendar Month
Longstone, St Maby, Bodmin, PL30





Property Description

A large end of terrace three bedroom house with oil fired central heating.

This good sized three bedroom family home is situated in the hamlet of Longstone, close to the beautiful village of St Mabyn & only 5.7 miles from the vibrant town of Wadebridge.

The property benefits from a large parking area for multiple cars at the front of the property & a few steps up to the front door. Inside, the house comprises: hallway leading into the lounge which has an electric fire. There is a spacious kitchen/diner which includes an electric oven & hob and space for other appliances. There is also a useful under stair cupboard. A door off the kitchen leads to the utility room which has plumbing for a washing machine and a cupboard containing the hot water cylinder. A door leads out to the rear courtyard.

Upstairs: master bedroom with built-in wardrobe, further double bedroom & single bedroom. All bedrooms have laminate wood-effect flooring. The bathroom has a mains fed shower over the bath.

To the rear is a small courtyard with outside W.C & large shed with light & power. The property has oil fired central heating.

Energy Rating E (54). Council Tax Band B. Deposit £1,065. No smokers or sharers. 1 dog or cat considered by negotiation.

Floorplan

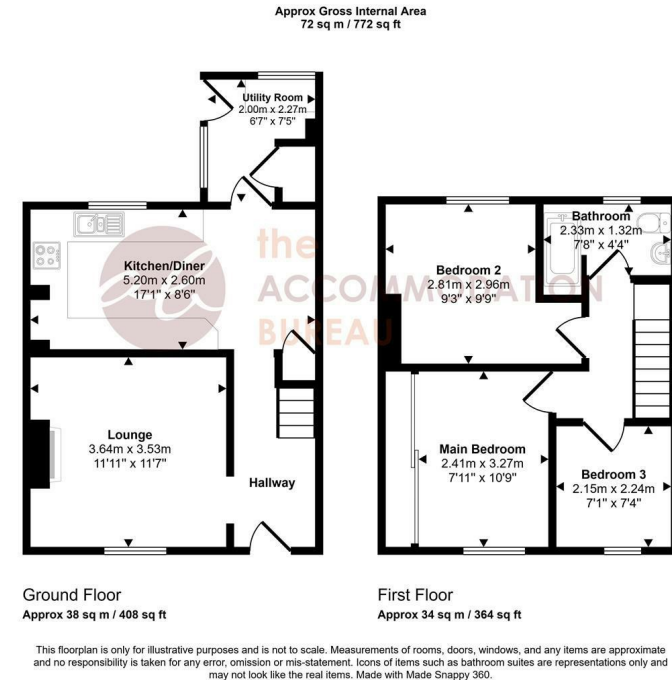

Location

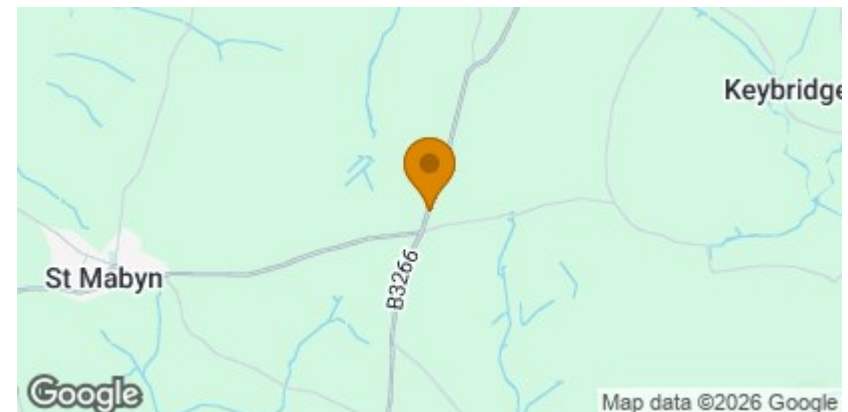

Features

- Rural Village Location
- End Of Terrace Property
- Shed
- Oil Fired Central Heating
- Kitchen With Oven & Hob
- Council Tax Band B

Letting Information

- Rent: £925 Per Calendar Month
- Holding Deposit: £100
- Total Deposit Required: £1,065
- Local Authority: Cornwall Council
- Council Tax Band: B
- Furnishing: Unfurnished
- Available From: 22nd May 2026

Energy Efficiency Rating

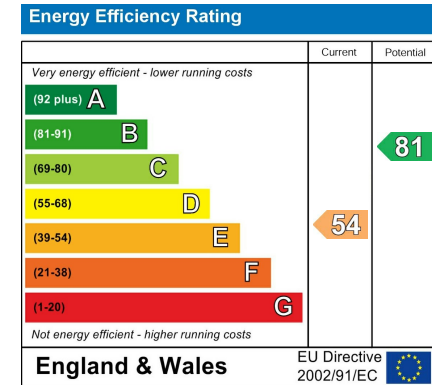

For further information, please call The Accommodation Bureau on 01208 78480.

7 Turf Street, Bodmin, PL31 2DJ. bodmin@theaccommodationbureau.com.

These particulars, whilst believed to be accurate are set out as a general outline only for guidance and do not constitute any part of an offer or contract. Prospective tenants should not rely on them as statements of representation of fact, but must satisfy themselves by inspection or otherwise as to their accuracy. No person in this firm's employment has the authority to make or give any representation or warranty in respect of the property.

