



Sales.

North Street,  
Horsham, RH13 5TT

Asking Price  
£200,000



**North Street,  
Horsham, RH13 5TT**



A beautifully presented one large double bedroom raised ground floor apartment with resident parking. The property is situated in an exclusive development, within walking distance of the railway station and town centre. The accommodation comprises: kitchen/sitting/dining room fitted with an attractive range of high gloss units with integrated appliances. The property further boasts a west facing balcony. There is a double bedroom with fitted wardrobes and a modern bathroom with a white suite and shower over the bath. Benefits include double glazed windows, central heating, security entry system and there is lift that provides direct access to resident parking.

There is a permit for underground parking at Horsham gates with access to all blocks, bin and bike store. The property has a west facing balcony with room for furniture to sit and enjoy the evening sun.



**ADDITIONAL INFORMATION**

Tenure: Leasehold  
Lease Term: 125 Years from 1 January 2017  
Service Charge: £1,652 per annum  
Service Charge Review Period: tbc  
Ground Rent: £250 per annum  
Ground Rent Review Period: tbc

**AGENTS NOTE**

We strongly advise any intending purchaser to verify the above with their legal representative prior to committing to a purchase. The above information has been supplied to us by our clients/managing agents in good faith, but we have not necessarily had sight of any formal documentation relating to

Viewing arrangements by appointment through:

**Brock Taylor**  
**01403 272022**  
**horshamsales@broctaylor.co.uk**

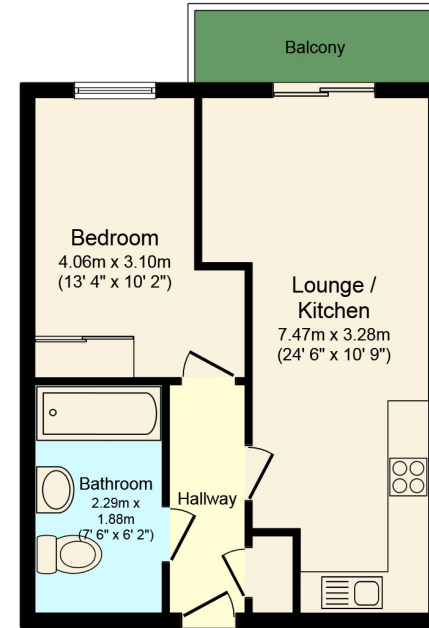

Total floor area 43.0 sq. m. (463 sq. ft.) approx  
Floor area 43.0 sq. m. (463 sq. ft.) approx  
This floor plan is for illustration purposes only and may not be representative of the property. The position and size of doors, windows and other features are approximate. Unauthorized reproduction prohibited. © PropertyBOX



**Buses**  
1 minute walk



**Shops**  
Lidl  
1 minute walk



**Trains**  
Horsham  
4 minute walk



**Sport & Leisures**  
Pavilions in the Park  
8 minute walk



**Rental Income**  
£tbc pcm



**Schools**  
Kingslea Primary  
The Forest School



**Fibre  
Broadband**  
Up to 1000 Mbps



**Roads**  
M23  
5.7 miles



**Council Tax**  
Band C

**Map Location**

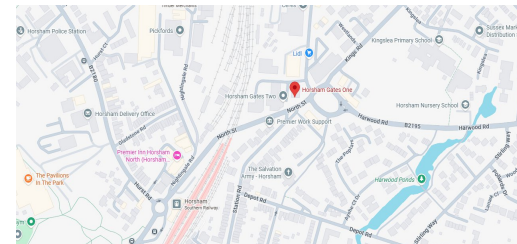

**EPC Rating**

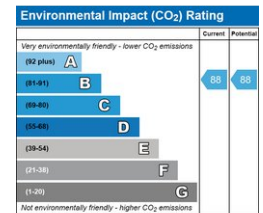
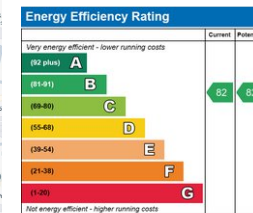

Brock Taylor Disclaimer: we would like to inform prospective purchasers that these sales particulars have been prepared as a general guide only. A detailed survey has not been carried out, nor the services, appliances and fittings tested. Room sizes should not be relied upon for furnishing purposes and are approximate. If floor plans are included they are for guidance only and illustration purposes only and may not be to scale. If there are any important matters likely to affect your decision to buy, please contact us before viewing this property.

**Residential sales, lettings,  
land and new homes.**

**01403 272022**  
**brocktaylor.co.uk**  
2-6 East Street, Horsham West Sussex, RH12 1HL