

Peppermint Drive

COLBURN



LOVE PROPERTY.

LOVE THE JOURNEY

Peppermint Drive

Found in Colburn, this beautiful and stylish three-bedroom home is ideal for first-time buyers, young families or investors.

Located here, you're close to shops, schools, and have great access routes to the A1.

As you step through the entrance, you're welcomed straight into the kitchen-diner, a warm and inviting space that immediately feels like the heart of the home. The thoughtfully styled décor complements the cream cabinetry beautifully, enhancing the natural light and creating a bright, uplifting atmosphere. It's a room designed for everyday living, whether that's enjoying relaxed family meals around the table or giving the children a comfortable spot to focus on their homework.

Leading on from the kitchen, the lounge continues the home's cohesive and stylish feel. Thoughtfully presented, this space features a contemporary electric fire that creates a natural focal point. There is ample room for two generously sized sofas, making it ideal for relaxing or entertaining. A large window allows natural light to pour in, enhancing the bright and airy atmosphere.

There is also a conveniently located downstairs WC, positioned neatly at the foot of the stairs.



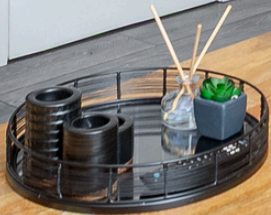



Upstairs...

Upstairs, the property features three well-proportioned bedrooms. Two are generous doubles, while the third is a spacious single, perfectly suited as a nursery or home office. Each room is neatly presented and thoughtfully laid out, offering flexibility for family life as needs evolve.

The family bathroom is well presented with a white contemporary finish, featuring a bath with overhead shower, WC, and wash basin. It offers a comfortable and practical space suited to everyday living.





Outside

To the front of the property there is a paved area for garden furniture so you can enjoy the sunshine and children can play.

To the rear of the property is an enclosed yard, the perfect place for a few potted plants and some patio furniture.

Finer Details

Postcode: DL9 4UF

Freehold

Council Tax Band: A

EPC Rating: TBC

Non-Standard Construction (concrete)

Gas Central Heating



Peppermint Drive Colburn

Total area: approx. 77.4 sq. metres (833.7 sq. feet)

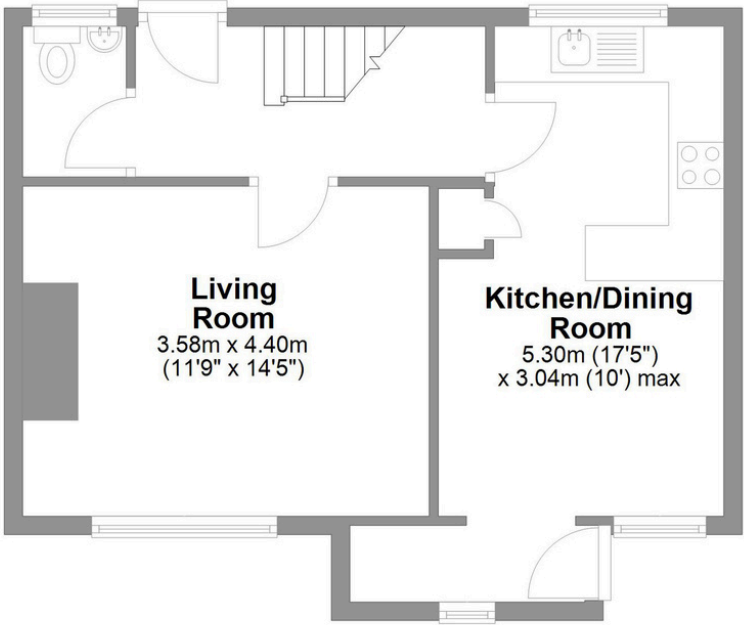

Ground Floor
Approx. 39.6 sq. metres (426.6 sq. feet)

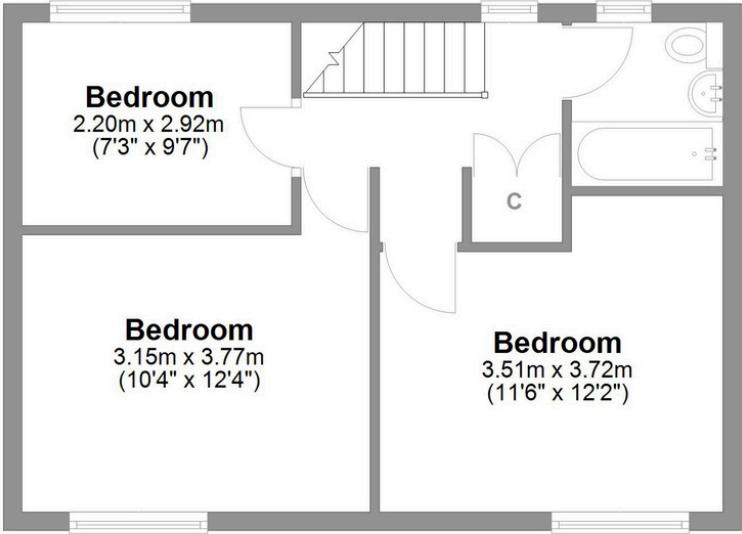

First Floor
Approx. 37.8 sq. metres (407.1 sq. feet)

LOVE PROPERTY

Whilst every attempt has been made to ensure the accuracy of the floorplans contained here, measurements of doors, windows, rooms and any other items are approximate and no responsibility is taken for any error, omission or mis-statement. This plan is not drawn to scale and is for illustrative purposes only & should be used as such by any prospective purchaser.
Created especially for Love Property by Vue3sixty Ltd