

OUTWOOD

SCURRAGH LANE

LOVE PROPERTY.

LOVE THE JOURNEY



Scurragh Lane, Skeeby

Set on Scurragh Lane in Skeeby, this location is within close reach of amenities and has the convenience of Richmond just a short drive away. With Scotch Corner moments from your doorstep, connecting to the A1 and A66 is straightforward, making this an ideal base for commuters as well as those looking to stay connected while enjoying a more relaxed setting.

The village of Skeeby has lots to get involved with, including a community-run pub, an active village hall, and there's also a regular bus service connecting you to nearby towns and villages.



Welcome home...

Approaching the property, the gated driveway opens into a frontage with space for multiple vehicles, bordered by planted areas that soften the entrance. With fields set just opposite, there's an immediate sense of openness.

Inside, the layout is simple and easy to navigate. The living room sits to the front, where a large window brings in natural light and frames the outlook. An open fire means you can enjoy cosy evenings in, in the colder months, making this a room that feels particularly inviting as the evenings draw in.

The kitchen sits to the rear, fitted with a range of units and appliances that are all set to remain, making the move that bit easier.





Time for bed...

Both bedrooms are comfortable doubles. The main bedroom looks out over the back garden and includes built-in wardrobes, while the second bedroom sits to the front and offers flexibility, whether used for guests, a study, or an additional sitting room. The bathroom has been updated in recent years and includes a bath with an overhead shower, finished in a clean, neutral style.







Outside...

The garden is where this home really comes into its own. Stepping out from the kitchen, a decking area provides a natural spot for outdoor dining before leading onto a generous lawn. Established planting, a greenhouse, and additional outbuildings create a space that's well-suited to anyone who enjoys gardening or simply spending time outside. To the left, a garage offers useful storage or workshop potential.





Scurragh Lane Skeeby

Total area: approx. 81.3 sq. metres (874.8 sq. feet)

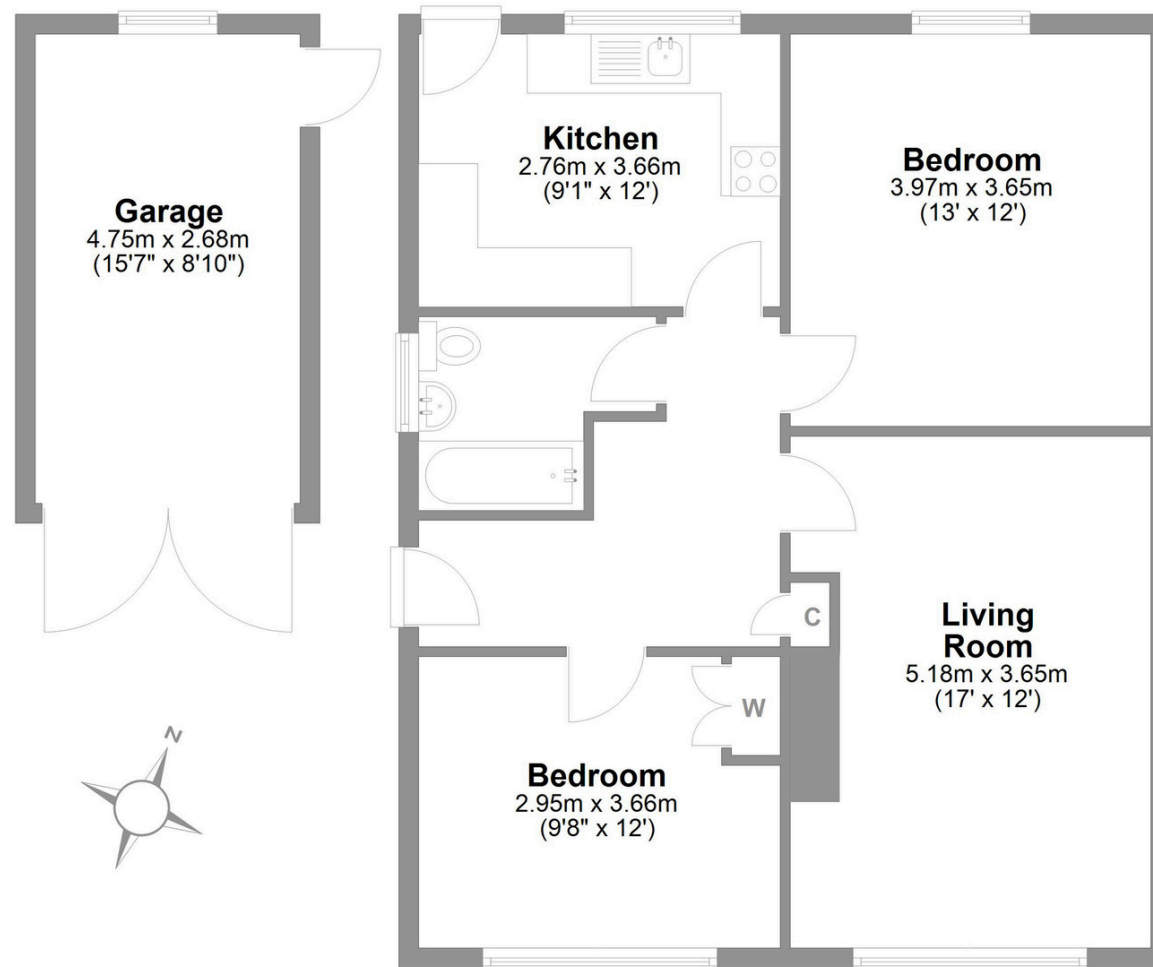

LOVE PROPERTY.♡

Whilst every attempt has been made to ensure the accuracy of the floorplans contained here, measurements of doors, windows, rooms and any other items are approximate and no responsibility is taken for any error, omission or mis-statement. This plan is not drawn to scale and is for illustrative purposes only & should be used as such by any prospective purchaser. Created especially for Love Property by Vue3sixty Ltd