





WINSTON ROAD

A quaint mid terrace home situated in a popular village location with a cosy living room with log burner, fitted kitchen, two bedrooms and a bathroom to the first floor landing. A lovely starter home, ideal for a single person or couple starting out. Available immediately.

LOCATION

Staindrop has close links to Barnard Castle and Darlington and is close by to Raby Castle. There is a variety of shops in the village, including a renowned butchers, tea-rooms, and a pub. There is also a church, doctors surgery and school.

IMPORTANT INFORMATION

Postcode: DL2 3NN.

Style of property: Mid terrace house.

Council tax band: A - Durham County Council.

EPC Rating: D.

Heating type: Gas central heating and a log burner in the living room.

Parking: Parking is on road on a first come first served basis.

Appliances included: Integrated oven, hob and extractor.

Pets: This property is not ideal for pets subject to the lack of outside space.

Term: The landlord is looking for long term tenants.

Available from: Immediately.

What3words:///parsnips.situation.position



WANT TO VIEW? THINGS YOU NEED TO KNOW BEFORE HAND....

IF YOU THINK THIS PROPERTY IS FOR YOU, CLICK ON THE LINK TO EMAIL AND FILL OUT THE QUESTIONNAIRE, WE WILL BE IN TOUCH AS SOON AS POSSIBLE TO ARRANGE A VIEWING APPOINTMENT.

Affordability: It is important, that before you enquire about the property, you check whether it is affordable for you. As per our referencing companies requirements you will need a combined income of £18,000.

Holding Deposit: You will need to pay a holding deposit that is equivalent to 1 weeks rent (£138.00) and provide some personal and financial information (3 months bank statements) in order for us to commence with the referencing process. Your holding deposit will be deducted from your first months rent or refunded to you after 15 calendar days, whichever you are agreeable to. Please note that failure to disclose adverse credit may result in the loss of your holding deposit.

Deposit: The bond for this property is £692.00 This will be refunded at the end of the tenancy subject to terms and conditions.



Winston Road Staindrop

Total area: approx. 78.5 sq. metres (845.1 sq. feet)

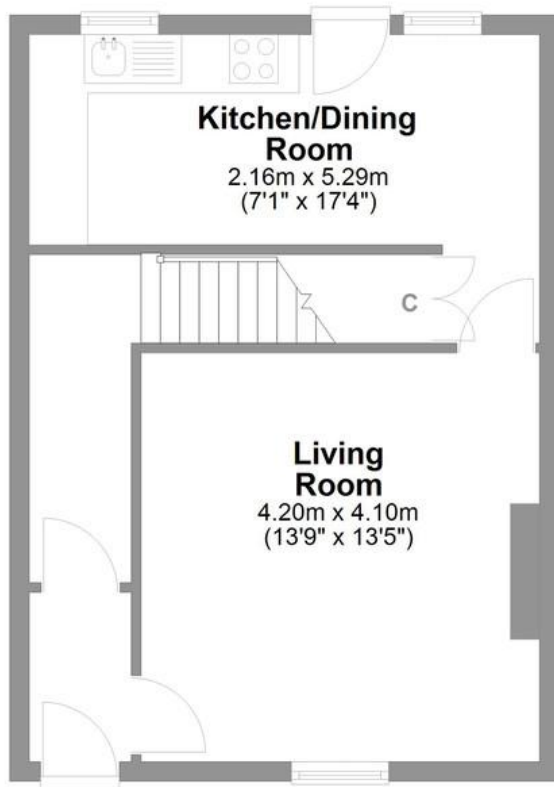

Ground Floor

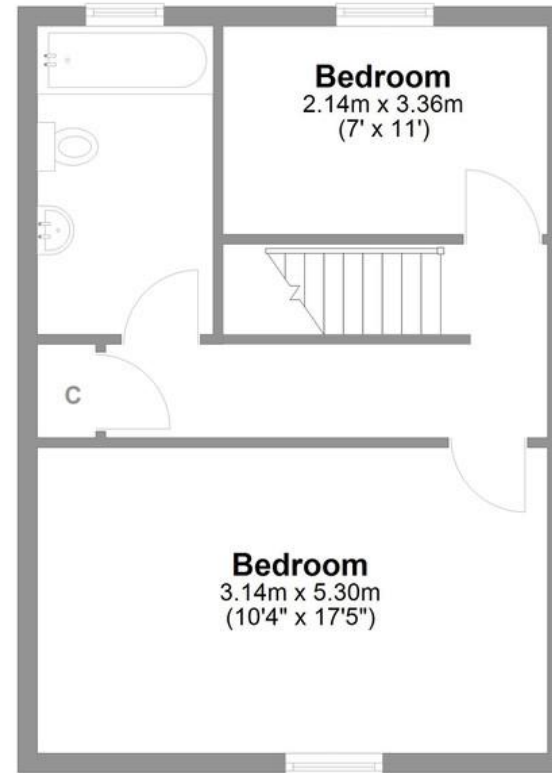

First Floor



LOVE PROPERTY.

Whilst every attempt has been made to ensure the accuracy of the floorplans contained here, measurements of doors, windows, rooms and any other items are approximate and no responsibility is taken for any error, omission or mis-statement. This plan is not drawn to scale and is for illustrative purposes only & should be used as such by any prospective purchaser. Created especially for Love Property by Vue3sixty Ltd

01748 834 373
lets@lovepropertyuk.co.uk
find us on Facebook
@lovingproperty

Catterick Garrison

18 Richmond Road, Catterick
© 2016 Love Property UK Ltd

Company Registration No. 6779915
www.lovepropertyuk.co.uk