



MAXWELLS



7 Bennett Drive, Banbury, Oxfordshire. OX16 1HX
Guide Price £360,000 - Freehold



PROPERTY DESCRIPTION

Located at the end of a quiet residential cul de sac and occupying a much larger than normal plot is this beautifully presented semi detached family home. Offering a large driveway, beautiful landscaped south facing rear garden with home office/garden room and three bedrooms with an en suite to the master. This property needs to be viewed to appreciate the outside space and delightful garden.

The property is set back from the road with a small front garden laid to lawn and pathway leading to the front door, to the side is a big driveway with up and over door to the garage and timber gate leading to the side and rear gardens. From the hallway are stairs rising to the first floor landing and a door leading into the sitting. With plenty of space for a furniture, a door leading to the kitchen and a double glazed window to the front aspect the sitting room is a lovely space to spend time in. Located on the rear of the house, the kitchen/dining room is a light and spacious room with double glazed windows and French doors leading to the south facing rear garden. There is a comprehensive range of cabinets plus a selection of integrated appliances while off the kitchen is a small utility area with a door leading to the cloakroom.

From the first floor landing are doors leading to all bedrooms, the family bathroom and access to the loft space. The master bedroom has a double glazed window looking over the landscaped rear garden, built in double wardrobes and a door to the en suite shower room. Bedrooms two and three are both on the front of the house with double glazed windows. The family bathroom is fitted with a white three piece suite and tiling to the splash prone areas.

The south facing rear garden has been landscaped and lovingly maintained to offer plenty of sun when you want it and shade when you need it. There is a covered patio area that runs the width of the property and a pathway that leads to the side of the house where you can find a side garden that is currently laid to paving with a large timber shed. The garden itself is laid to lawn with a selection of bright and attractive flowers and shrubs, all enclosed by timber fencing. The left hand side of the garden is a large timber built home office/garden room with large glazed double doors and a composite decked area, perfect for enjoying those long summer evenings.

Agents note: we understand that a management fee of is paid annually. We understand the property is connected to mains gas, electricity, water and drainage. Heating and hot water is currently provided by a mains gas fired boiler.

POINTS OF INTEREST

- Landscaped, South Facing Rear Garden
- Quite Cul De Sac Location
- Larger Than Normal Plot
- Three Bedrooms
- En Suite To Master Bedroom
- Sitting Room
- Fitted Kitchen / Dining Room
- Timber Built Home Office / Garden Room
- Large Driveway
- EPC Rated B

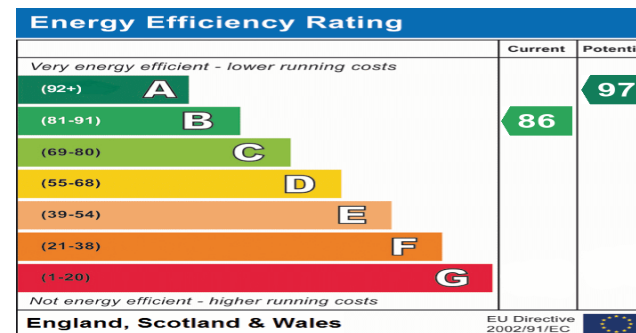

GROUND FLOOR
65.9 sq.m. (709 sq.ft.) approx.

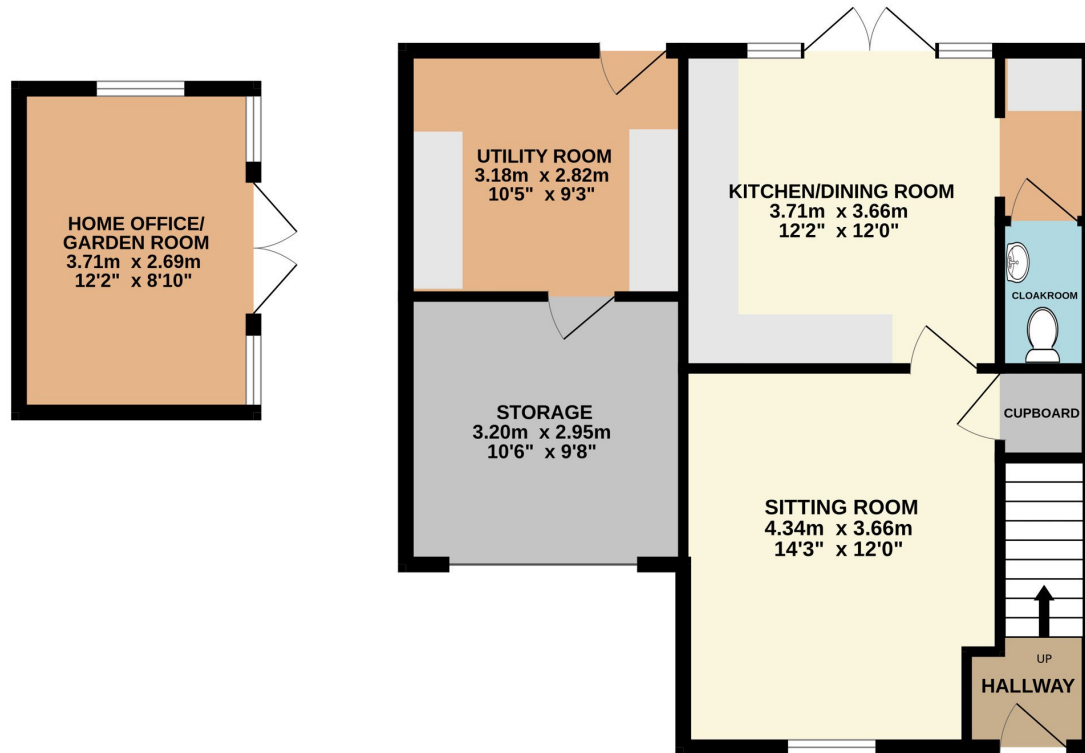

1ST FLOOR
37.2 sq.m. (400 sq.ft.) approx.

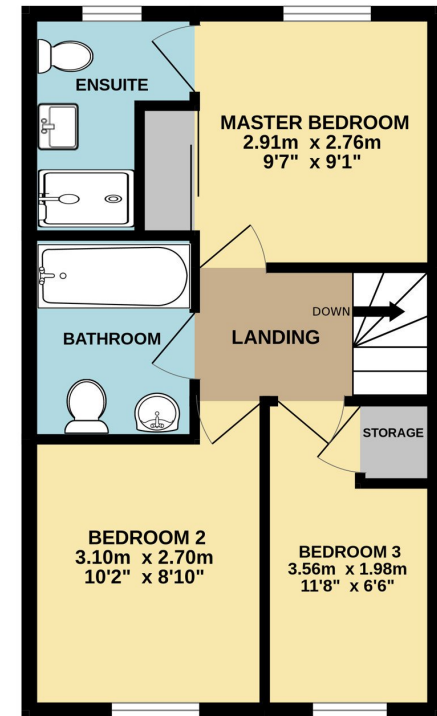

TOTAL FLOOR AREA : 103.0 sq.m. (1109 sq.ft.) approx.

Whilst every attempt has been made to ensure the accuracy of the floor plan contained here, measurements of doors, windows, rooms and any other items are approximate and no responsibility is taken for any error, omission or mis-statement. This plan is for illustrative purposes only and should be used as such by any prospective purchaser.
Made with Metropix ©2026

