

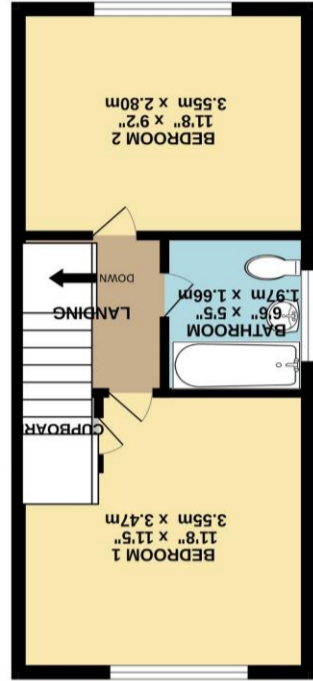

Whilst every attempt has been made to ensure the accuracy of the floorplan contained herein, measurements of doors, windows, rooms and other areas are approximate and no responsibility is taken for any omission or mis-statement. This plan is for guidance purposes only and should be used as such by any prospective purchaser. The services, systems and appliances shown have not been tested and no guarantee is made as to their operation or efficiency and they are given as to their operation or efficiency can be given.

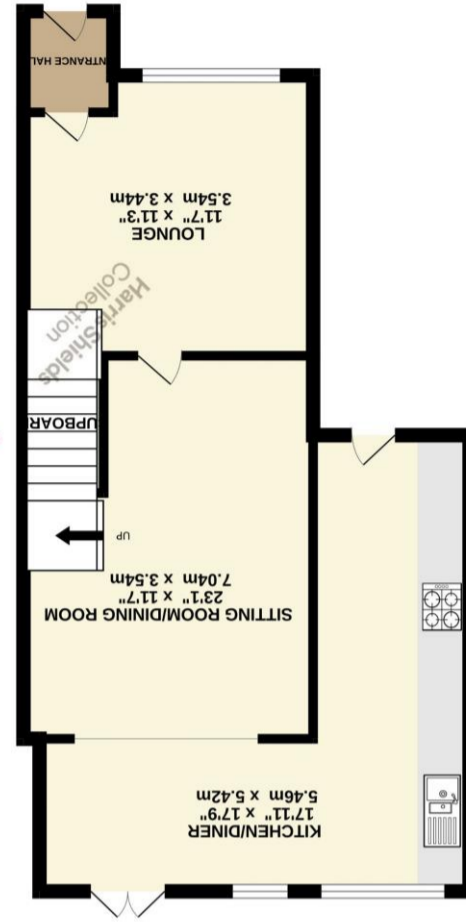

1ST FLOOR  
321 sq ft (29.5 sq m), approx.



GROUND FLOOR  
520 sq ft (48.3 sq m), approx.



24 The Copse, Scarborough, North Yorkshire,  
 YO12 5HG

**Harris Shields**  
 Collection

## A two bedroom semi detached house

- ✓ Extended Semi Detached Home
- ✓ Two Double Bedrooms
- ✓ Extended Dining Kitchen Area
- ✓ Offered With No Onward Chain
- ✓ Close To The Hospital
- ✓ Driveway & Gardens.

Asking Price £180,000

# Harris Shields Collection

Harris Shields Collection, 25 Northway, Scarborough  
North Yorkshire, YO11 1JH

01723 341557

[mail@harris-shieldscollection.uk](mailto:mail@harris-shieldscollection.uk)

<https://harris-shieldscollection.uk/>

### Description

Located within a cul-de-sac, close to the hospital, this modern extended two double bedroom semi-detached home benefits from gas central heating and uPVC double glazing. The accommodation comprises an entrance vestibule, a front-facing lounge, and a spacious dining room leading through to an extended kitchen fitted with a built-in oven, hob, and extractor. French doors complement the dining area and open out onto the rear garden. To the first floor are two double bedrooms (one front-facing and one rear-facing) and a fully tiled bathroom fitted with a white suite and shower over the bath. Externally, the rear garden is fully enclosed and features a combination of gravelled area and lawn. To the front, there is a driveway providing off-street parking, along with a lawned garden bordered by a hedge. The property is offered for sale with no onward chain.

### Additional Information

Council tax band



Opening doors  
for over 60 years

Harris Shields  
Collection