

37 MARTON AVENUE, BRIDLINGTON, YO16 7DT
TOTAL APPROX. FLOOR AREA 753 SQ.FT. (70.0 SQ.M.)

REA 400 SQ.FT
(37.1 SQ.M.)

AREA 353 SQ.FT.
(32.8 SQ.M.)

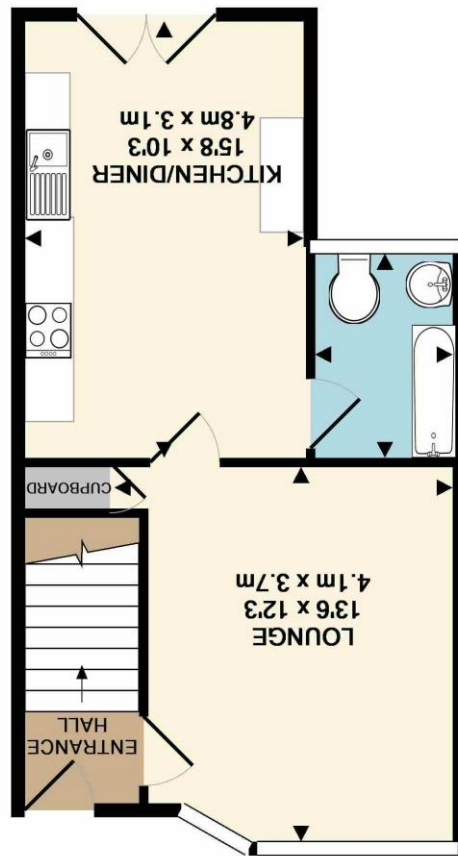

Harris Shields Collection

Ideal first home located in a popular residential area.

- ✓ Mid-terraced house
- ✓ Popular residential area
- ✓ Three bedrooms
- ✓ Lounge and fitted kitchen
- ✓ Front and rear gardens
- ✓ Close to schools and amenities
- ✓ Ideal first-time home or investment

Asking Price £149,995

Harris Shields Collection

Harris Shields Collection, 14 Promenade, Bridlington East Yorkshire, YO15 2PX

01262 601704
estateagents@harris-shieldscollection.uk
<https://harris-shieldscollection.uk/>

This 3 bedroom mid-terraced house is located in a popular residential area on the northern side of Bridlington, approximately one mile from the historic Old Town. The Old Town offers a wide range of restaurants, distinctive architecture, cultural attractions, antique and modern shops, traditional inns and art galleries.

The property briefly comprises an entrance hall, lounge, fitted kitchen/breakfast room, three bedrooms and a combined bathroom/W.C. Externally, there is an enclosed rear garden along with a small garden to the front.

The property benefits from UPVC double glazing to the majority of windows and gas central heating. In our opinion, it represents an excellent first-time buy, next-step home or buy-to-let investment.

Ideally suited to a small family, the property is conveniently located close to a selection of schools including Burlington Junior School, Martongate Junior School and Headlands Secondary School, along with a public library and supermarket nearby.

Additional Information

Council tax band A



Opening doors
for over 60 years

Harris Shields
Collection