

While every attempt has been made to ensure the accuracy of the figures contained here, measurements of doors, windows, rooms and other items are approximate and no responsibility is taken for any omission or misstatement. The plan is intended to provide a guide only and should not be used for any prospective purchase. The services, systems and appliances shown have not been tested and no guarantee as to their operability or efficiency can be given.

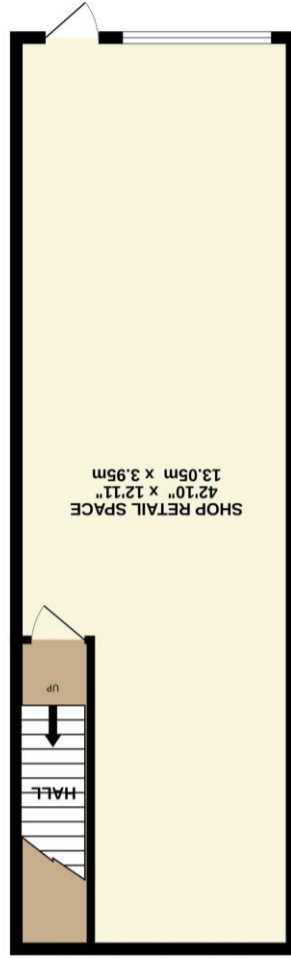

GROUND FLOOR (51.5 sq.m.) approx.



49 King Street, Bridlington, East Yorkshire, YO15 2DN

Harris Shields Collection

Prime Retail Premises – Bridlington Town Centre

- ✓ Great Location
- ✓ Long Lease Options
- ✓ Versatile Space
- ✓ High Visibility

Asking Price £8,750

An exceptional opportunity to secure a well-located ground floor retail unit in the heart of Bridlington, just a short walk from the main seafront and fronting onto busy King Street, the town's key retail thoroughfare.

The ground floor offers a versatile retail space, perfect for a wide range of business uses. The first floor is of a similar size and provides ample room for storage, office space, or potential further development.

This property enjoys a high footfall location with excellent visibility, making it ideal for both new ventures and expanding businesses.

Whether you are looking to establish a presence in a thriving area or grow your existing brand, this is a fantastic opportunity not to be missed.

Contact us today to arrange a viewing and secure your spot in one of Bridlington's prime commercial locations.

NB

Although a Fully Insuring & Repairing Lease a contribution toward Buildings Insurance is required.

Current rateable value £7,100.

Additional Information

Council tax band



Opening doors
for over 60 years

Harris Shields
Collection