

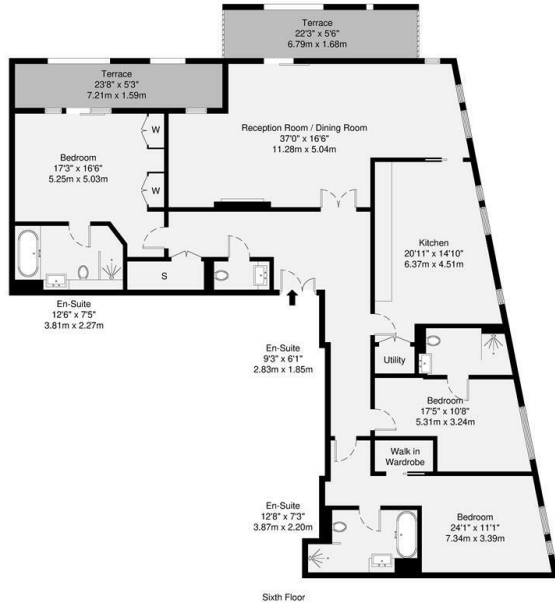

Strand, London

Price Guide £5,500,000



GROSS INTERNAL AREA (GIA)
187.1 sq m / 2013 sq ft

TOTAL STORAGE SPACE
(Storage and wardrobe areas)
3.9 sq m / 41 sq ft

EXTERNAL FEATURES
(Balcony, Terrace, Terrace, Terrace)
22.8 sq m / 245 sq ft

RESTRICTED HEAD HEIGHT
(Rooms are less than 2.0m)
0.0 sq m / 0.0 sq ft

Disclaimer: Floorplan measurements are approximate and are for illustrative purposes only. While we do not doubt the floorplan accuracy and completeness, you or your advisors should conduct a careful, independent investigation of the property in respect of monetary valuation.

Maison
VUE

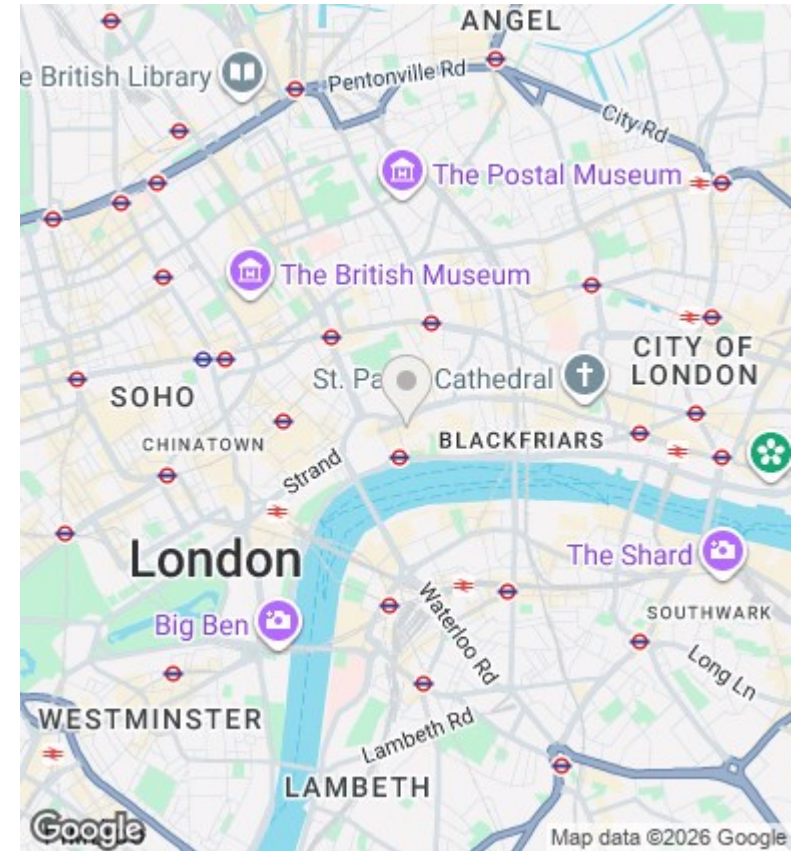

Directions

Viewings

Viewings by arrangement only. Call 02070990800 to make an appointment.

Council Tax Band

H

EPC Rating:

B

Energy Efficiency Rating		
	Current	Potential
Very energy efficient - lower running costs		
(92 plus) A		
(81-91) B	84	
(69-80) C		
(55-68) D		
(39-54) E		
(21-38) F		
(1-20) G		
Not energy efficient - higher running costs		
England & Wales	EU Directive 2002/91/EC	