



## 4 Curlew Close, Torquay – TQ2 7GH

Offers Over £260,000





## 4 Curlew Close

Torquay, Torquay

Situated in the sought-after Willows area of Torquay, this three-bedroom link-detached home offers well-balanced accommodation, with potential for modernisation throughout, off road parking, single garage and more...

Council Tax band: D

Tenure: Freehold

EPC Energy Efficiency Rating:

EPC Environmental Impact Rating:

- Link-detached family style home
- Situated in the sought after area of The Willows
- Plenty of kerb appeal with a stunning mature Cherry Blossom Tree, long driveway and single garage
- No onward chain
- Parking for 2-3 cars
- Low maintenance and mainly level rear garden
- Three bedrooms all with integrated storage
- Good sized lounge and conservatory for a light and airy feel throughout the downstairs
- Family bathroom, en-suite facilities and downstairs WC



# 4 Curlew Close

Torquay, Torquay

Curlew Close is situated within the popular Willows area of Torquay, a well-established residential neighbourhood that is particularly appealing to young families. The area is known for its quiet cul-de-sacs, family-friendly atmosphere and convenient access to a wide range of everyday amenities. Within easy reach is the well-known The Willows Retail Park, which provides a variety of supermarkets, shops, cafés and family-friendly restaurants, making day-to-day errands quick and convenient. Larger supermarkets including Sainsbury's and Marks & Spencer Foodhall are also close by. Families are particularly drawn to this area due to the selection of well-regarded schools nearby, including The Spires College and Shiphay Learning Academy, both of which are within a short drive. Families will also appreciate the proximity to local parks, green spaces and the beautiful South Devon coastline, offering plenty of opportunities for outdoor activities, weekend walks and days out by the sea.

## Absolute Sales & Lettings

Absolute Sales & Lettings Ltd, 13 Ilsham Road - TQ1 2JG

01803 214214

[torquay@movewithabsolute.co.uk](mailto:torquay@movewithabsolute.co.uk)

[movewithabsolute.co.uk/](http://movewithabsolute.co.uk/)



### Ground Floor

Approx. 46.1 sq. metres (495.9 sq. feet)

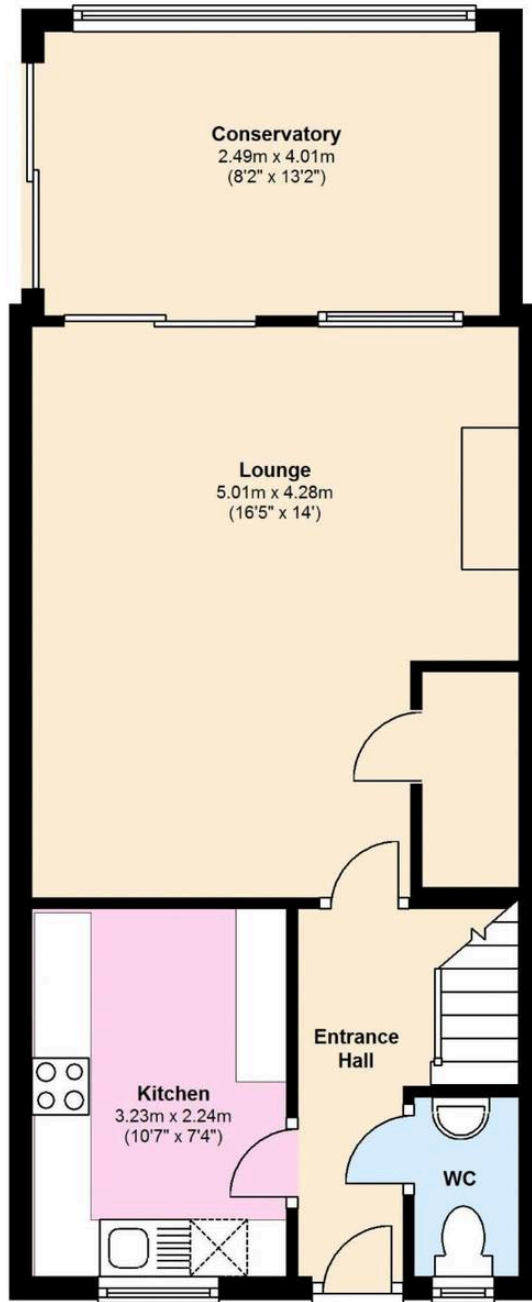

### First Floor

Approx. 36.2 sq. metres (389.4 sq. feet)

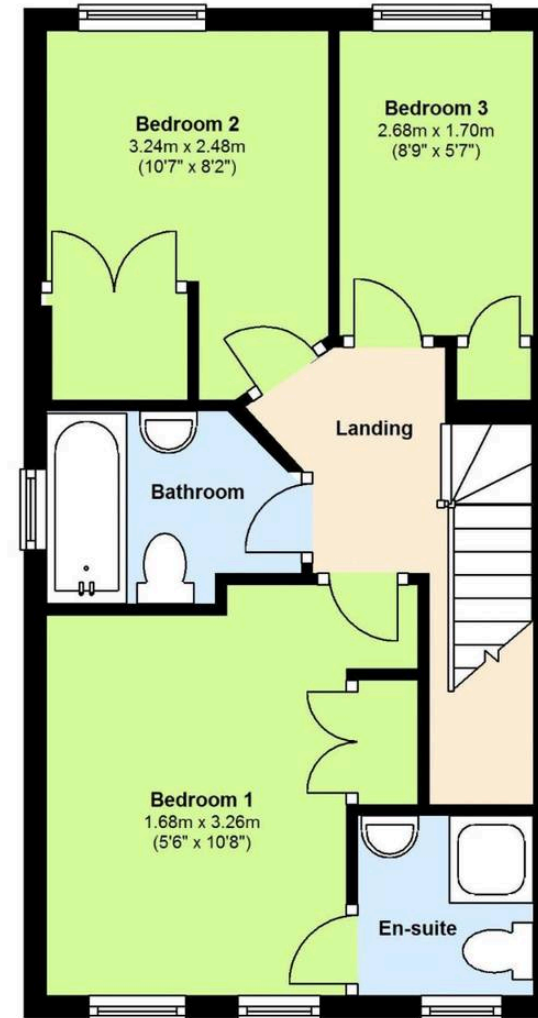

Total area: approx. 82.2 sq. metres (885.3 sq. feet)

