



88 Windmill Close, Brixham - TQ5 9SQ

Prices From £300,000

 **ABSOLUTE**  
SALES & LETTINGS



ABSOLUTE



## 88 Windmill Close

Brixham,

Spacious four double bedroom semi-detached house with driveway, garage, two shower rooms, and large lounge diner in a quiet cul-de-sac near schools, shops, and transport links. Council Tax band: C

Tenure: Freehold

EPC Energy Efficiency Rating: D

EPC Environmental Impact Rating: E

- Four double bedrooms
- Semi- detached house
- Off road driveway parking for up to 4 cars
- Large bright lounge diner
- Fitted kitchen
- Located near to local schools, bus stops and shops
- Two shower rooms
- Garage
- Quiet cul-de-sac location



## 88 Windmill Close

Brixham,

The property is situated less than 1/4 of a mile from Brixham town centre which boasts an array of shops, amenities and facilities as well as the picturesque harbour surrounded by a range of boutique shops, bars and restaurants. The main number 12 bus service can be found in the town centre with connections to the neighbouring towns of Paignton and Torquay. Both primary and secondary schooling are located within 1/4 of a mile level walk and a local convenience store situated on Great Rea Road is also just 1/3 of a mile level walk away.

### Absolute Sales & Lettings

Absolute Sales & Lettings, 36 Fore Street - TQ5 8DZ

01803 214214

[brixham@movewithabsolute.co.uk](mailto:brixham@movewithabsolute.co.uk)

[movewithabsolute.co.uk/](http://movewithabsolute.co.uk/)



### Ground Floor

Approx. 64.2 sq. metres (691.5 sq. feet)



### First Floor

Approx. 59.2 sq. metres (636.8 sq. feet)

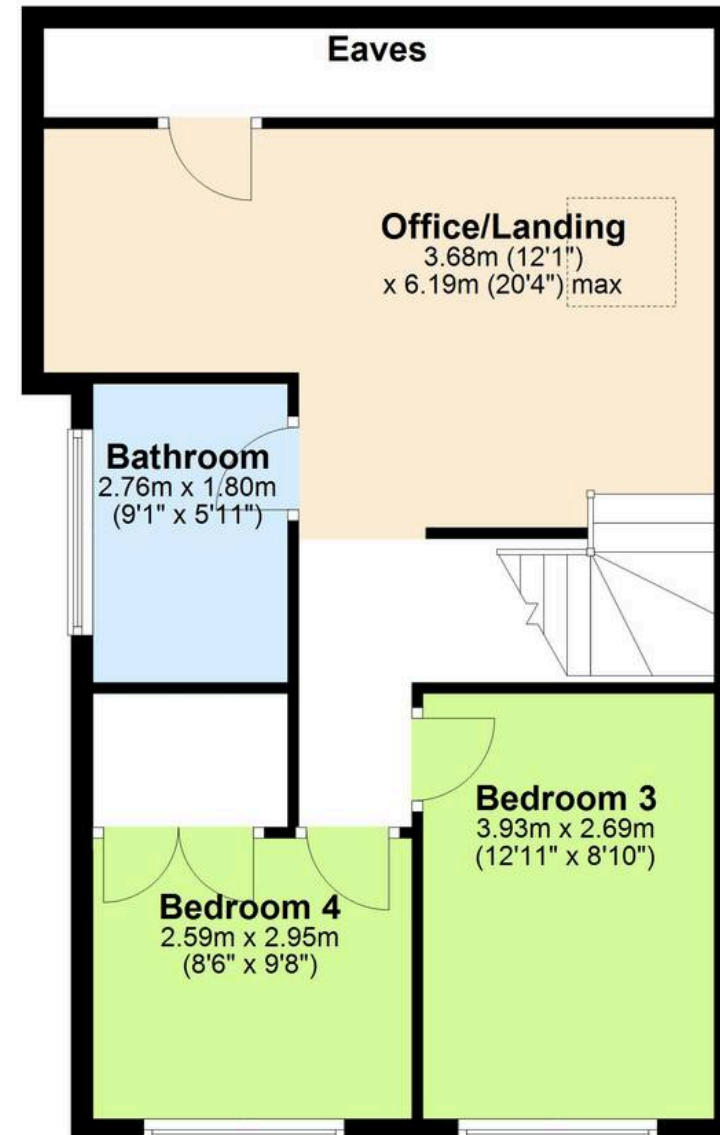

Total area: approx. 123.4 sq. metres (1328.2 sq. feet)

