



ABSOLUTE

Apt 10, Cedar House Orchid Way, Torquay – TQ2 8GW
£160,000





Apartment 10

Cedar House Orchid Way, Torquay

First-floor apartment with two bedrooms, 2 bathrooms, off road parking, lift access, panoramic views, and prime Willows convenience – your ideal modern home. Council Tax band: B

Tenure: Leasehold

EPC Energy Efficiency Rating: C

EPC Environmental Impact Rating: G

- Prime first-floor apartment with lift access and video entry.
- Two double bedrooms, including a principal en-suite with wardrobes
- Large main bathroom with bath/shower, heated towel rail and modern fittings
- Dual-aspect lounge/diner with balcony views.
- Private undercroft parking accessible through electric gates
- Impeccably maintained and move-in ready
- Proximity to Wren Retail Park and local amenities
- Ideal for commuters with easy access to major routes



Apartment 10

Cedar House Orchid Way, Torquay

Situated in the Willows, this apartment is perfectly placed for commuting in and out of Torbay. You're just about ten minutes from the town center and have quick access to routes leading to Exeter, Newton Abbot, and beyond. The nearby Wren Retail Park offers a range of shops and amenities, and you'll find a good selection of local primary and secondary schools, as well as convenient proximity to the hospital for healthcare professionals.

Absolute Sales & Lettings

Absolute Sales & Lettings Ltd, 13 Ilsham Road - TQ1 2JG

01803 214214

torquay@movewithabsolute.co.uk

movewithabsolute.co.uk/



First Floor

Approx. 69.8 sq. metres (750.8 sq. feet)

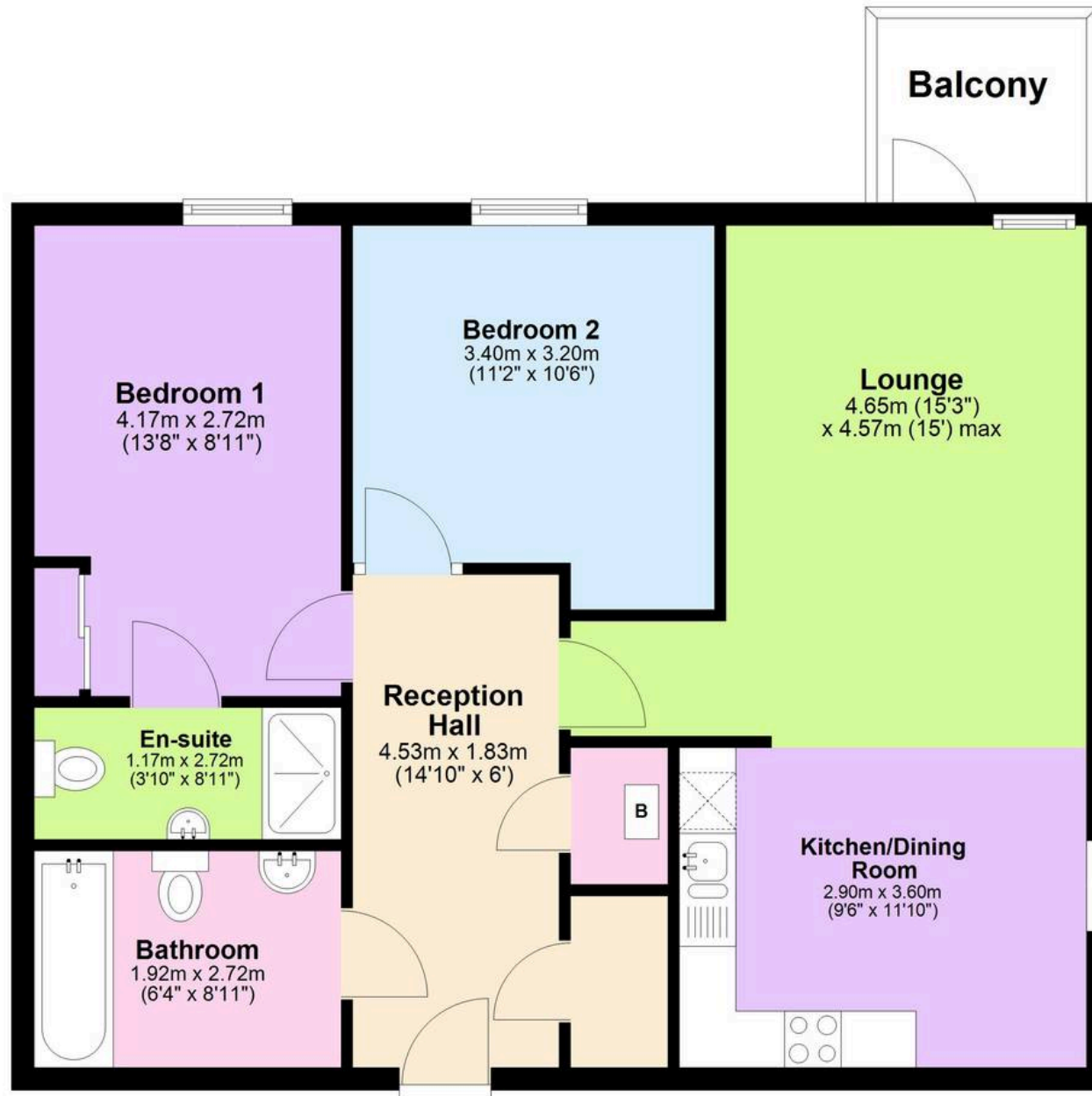

Total area: approx. 69.8 sq. metres (750.8 sq. feet)

