



Flat 6, Kentisknowle Kents Road, Torquay - TQ1 2NN
£160,000





Flat 6

Kentisknowle Kents Road, Torquay

Spacious 2-bed first floor maisonette in sought-after Wellswood, with lounge/diner, fitted kitchen, parking and no chain. Ideal for first-time buyers or investors in a prime location.

Council Tax band: C

Tenure: Leasehold

EPC Energy Efficiency Rating: E

EPC Environmental Impact Rating: E

- Spacious two-bedroom first floor maisonette
- Good-sized lounge/diner
- Fitted kitchen
- Two bedrooms
- Bathroom/WC
- Allocated parking for one car
- No onward chain
- Ideal for first-time buyers or investors
- Well-proportioned accommodation
- Much sought-after location in Wellswood



Flat 6

Kentisknowle Kents Road, Torquay

Wellswood is one of Torquay's most desirable residential areas, known for its village-style atmosphere and strong sense of community.

Wellswood Village is within easy reach, offering a selection of independent shops, cafés, restaurants, and everyday amenities. The area is also close to Ilsham Valley, Meadfoot Beach, and scenic coastal walks, making it particularly appealing to lifestyle buyers. Torquay harbour, marina, and town centre are easily accessible, along with good transport links, making Wellswood a highly sought-after location for both permanent living and investment.

Absolute Sales & Lettings

Absolute Sales & Lettings Ltd, 13 Ilsham Road - TQ1 2JG

01803 214214

torquay@movewithabsolute.co.uk

movewithabsolute.co.uk/



GROUND FLOOR

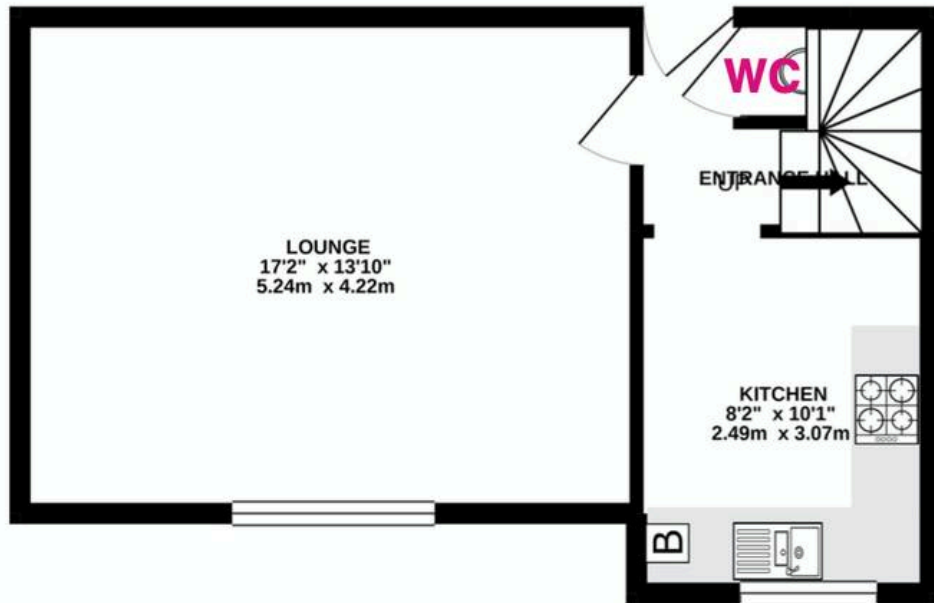

1ST FLOOR

