



7 Ansteys Close, Torquay - TQ1 2QP
£500,000

 **ABSOLUTE**
SALES & LETTINGS





7 Ansteys Close

Torquay, Torquay

Detached Georgian-style home in Wellwood with sea views, 3 bedrooms, 2 bathrooms, garage, parking, patio garden and superb access to village shops and coastal walks
Council Tax band: F

Tenure: Freehold

EPC Energy Efficiency Rating:

EPC Environmental Impact Rating:

- Detached Georgian-style residence in prestigious Wellwood cul-de-sac
- Originally built by reputable local firm Messrs Stoneman
- Superb elevated outlook towards Babbacombe and Lyme Bay
- Approximately 1,550 sq. ft. of well-balanced accommodation
- Spacious sitting room with fireplace and garden access
- Versatile sun lounge enjoying sea views.
- Separate dining room with attractive bay window
- Three bedrooms, including principal bedroom with en-suite.
- Integral garage and driveway parking
- Low-maintenance rear patio garden with brick-built store



7 Ansteys Close

Torquay, Torquay

Anstey's Close is positioned in the heart of Wellswood, one of Torquay's most sought-after residential areas, admired for its village atmosphere, elegant homes, coastal access and day-to-day convenience. For buyers relocating from out of the area, Wellswood offers a particularly attractive balance: a peaceful and affluent residential setting, yet with shops, cafés, restaurants, beaches, walks and transport links all within easy reach. Wellswood Village provides an excellent selection of local amenities, including a Co-op convenience store, pharmacy, post office, delicatessen-style food shops, cafés, restaurants, pubs, hairdressers and other independent businesses. The popular Kents pub, local cafés and village eateries give the area a strong community feel, while Torquay town centre, harbour and marina are only a short drive away for a broader choice of restaurants, leisure facilities and waterside attractions. The surrounding coastline is a major part of the appeal. Anstey's Cove is nearby and is known for its sheltered shingle beach, woodland surroundings, clear water and access to

Absolute Sales & Lettings

Absolute Sales & Lettings Ltd, 13 Ilsham Road - TQ1 2JG
01803 214214

torquay@movewithabsolute.co.uk

movewithabsolute.co.uk/

impressive clifftop promenades in the area, with views across Lyme Bay. From there, buyers can enjoy the historic cliff path to the beach, a variety of cafes and restaurants. The first part of the route is described as a short but fairly strenuous clifftop walk, with notable wildlife



ABS

Ground Floor

Approx. 89.6 sq. metres (964.2 sq. feet)



First Floor

Approx. 54.5 sq. metres (586.6 sq. feet)

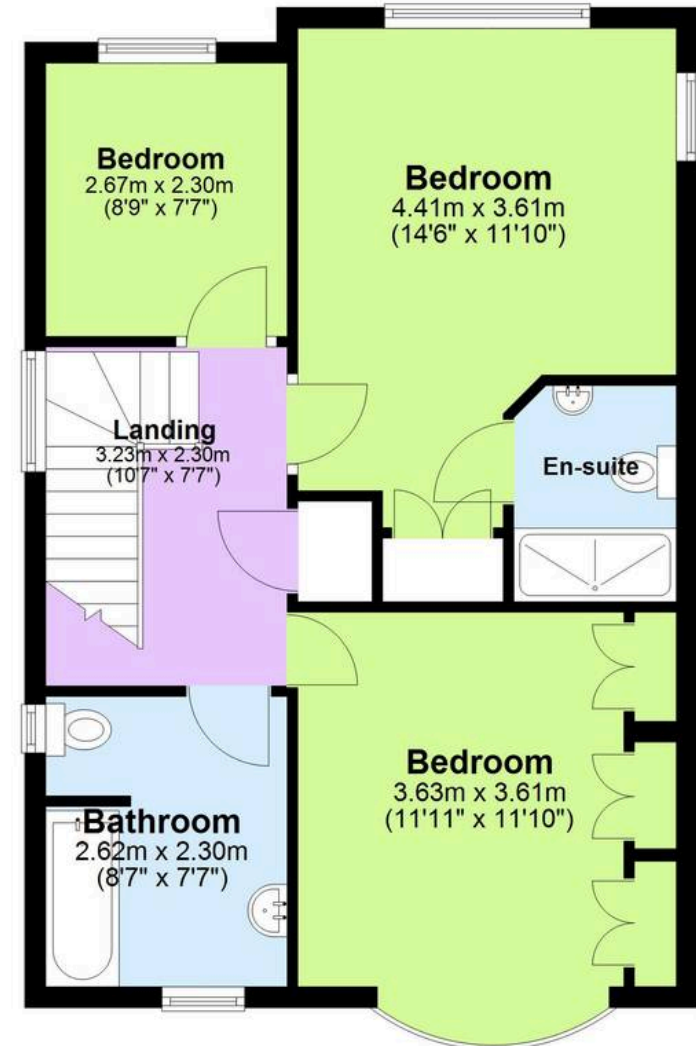

Total area: approx. 144.1 sq. metres (1550.8 sq. feet)

