



Flat 23, New Esplanade Court Esplanade Road, Paignton

Paignton

Guide Price **£78,000**



Flat 23

New Esplanade Court Esplanade Road,
Paignton

Ground floor flat near Paignton seafront. Lounge with modern kitchen, spacious double bedroom, bathroom/wc. Communal heated swimming pool. Allocated parking. Close to amenities. Council Tax band: A

Tenure: Leasehold

EPC Energy Efficiency Rating: E

EPC Environmental Impact Rating: E

- Ground floor purpose built flat
- Holiday Lets Allowed
- Short walk to Paignton sea front
- Double bedroom with built in wardrobes
- Lounge with modern kitchen area
- Communal heated swimming pool
- Ideal FTB/Investment opportunity
- Allocated parking space
- No onward chain



Flat 23

New Esplanade Court Esplanade Road,
Paignton

The property is located in a popular area only a short walk to Paignton sea front with its choice of beaches and amenities. Paignton town centre is also only a short walk away and offers a variety of shops, cafes and restaurants. For the walking enthusiast there is the stunning coastal walk linking the nearby towns of Brixham and Torquay. Paignton also has a railway station which connects to the mainline station in Newton Abbot.

Absolute Sales & Lettings

Absolute Sales & Lettings, 27 Hyde Road - TQ4 5BP

01803 890110

paignton@movewithabsolute.co.uk

<http://www.movewithabsolute.co.uk>



Ground Floor

Approx. 39.5 sq. metres (425.2 sq. feet)

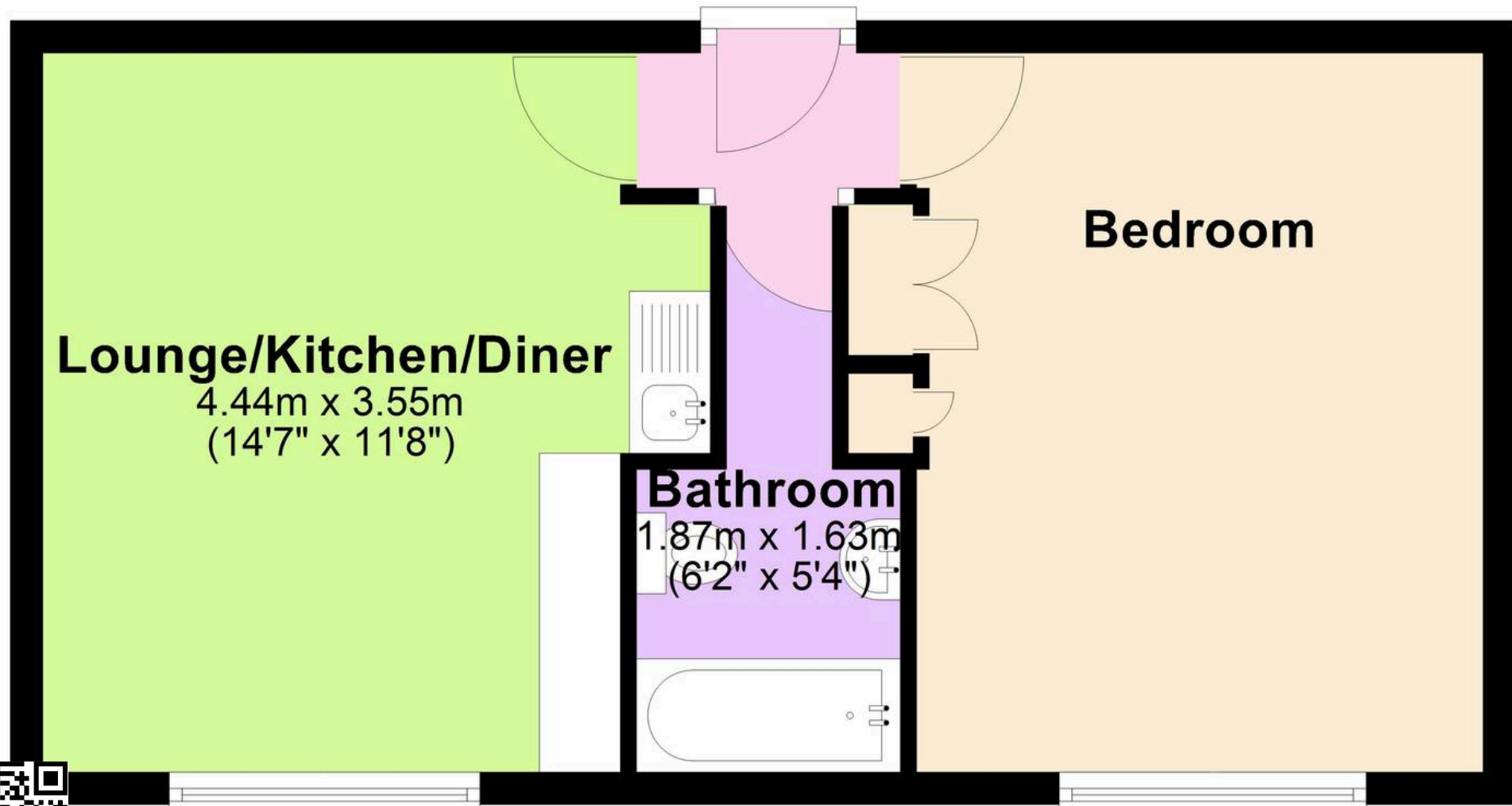

Total area: approx. 39.5 sq. metres (425.2 sq. feet)