



28a Headland Park Road, Paignton

Paignton

£210,000



## 28a Headland Park Road

Paignton

Spacious three bedroom first floor apartment with some sea views, private entrance, modern kitchen and bathroom, parking and no onward chain, situated close to Preston Sands Council Tax band: C

Tenure: Share of Freehold

EPC Energy Efficiency Rating: C

EPC Environmental Impact Rating: C

- A spacious 3 Bed First Floor apartment
- Popular Residential Position Within Lower Preston 500 yards from the sea front
- Modern Fitted Kitchen With Built In Appliances
- Offered with No Forward Chain
- Off Road Parking For Small Car or outside space
- Generous Sitting Room & contemporary fitted 4 piece bathroom
- Spacious Reception Hallway
- Close To Preston & Oldway Primary Schools
- uPVC Double Glazing & Gas Central Heating
- EPC- C & Council Tax Band- B



# 28a Headland Park Road

Paignton

Location Summary Situated within the highly desirable coastal suburb of Preston enjoys one of Paignton's most sought-after residential settings, combining easy access to the seafront with excellent local amenities, schools and transport links. Preston has long been popular with families, retirees and those relocating to the English Riviera due to its balance of convenience and coastal lifestyle. Preston's bustling shopping parade is within easy reach, offering a variety of independent shops, cafés, restaurants, convenience stores, pharmacies and everyday services. Larger supermarkets and retail facilities can be found nearby in Paignton town centre and at the Yalberton and Brixham Road retail parks. One of the area's biggest attractions is Preston Sands, a family-friendly beach forming part of the stunning Paignton seafront.

## Absolute Sales & Lettings

Absolute Sales & Lettings, 27 Hyde Road - TQ4 5BP

01803 890110

[paignton@movewithabsolute.co.uk](mailto:paignton@movewithabsolute.co.uk)

<http://www.movewithabsolute.co.uk>



# First Floor

Approx. 75.5 sq. metres (812.3 sq. feet)

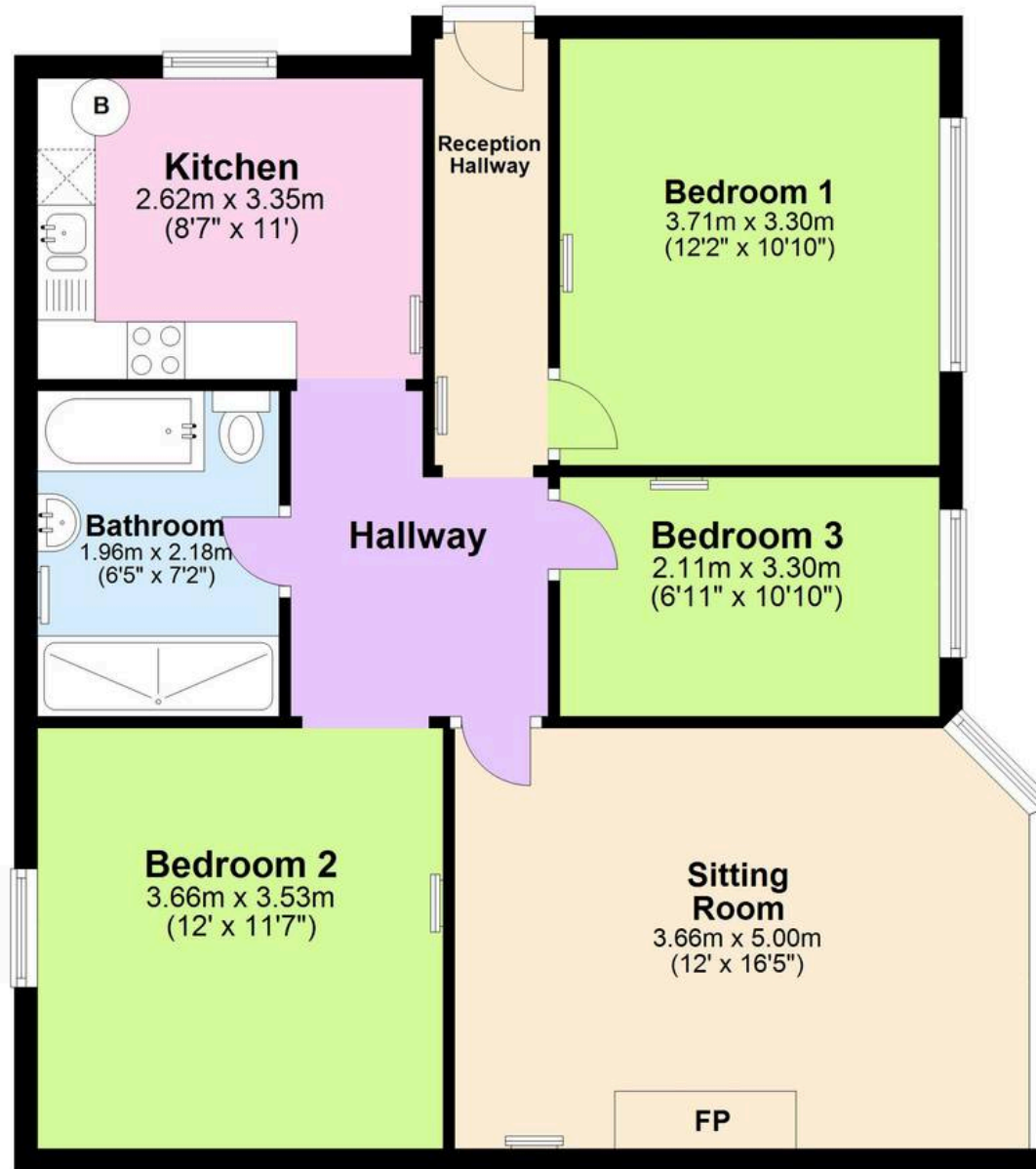

Total area: approx. 75.5 sq. metres (812.3 sq. feet)

Approx  
Plan produced using PlanUp.

