



Sharkham Drive, Brixham – TQ5 9FU

Guide Price **£580,000**





Sharkham Drive

Brixham,

New Guide Price Stunning 4-bed town house with breathtaking countryside and sea views. Luxury interiors with 2 en-suites, and integral garage. Beautiful garden, short stroll to beaches and coast paths.

Council Tax band: E

Tenure: Freehold

EPC Energy Efficiency Rating: B

EPC Environmental Impact Rating: B

- Beautiful town house
- 2 en-suites, family bathroom and separate WC
- Countryside and sea views
- Stone's throw from the South West coastal paths
- Driveway for up to 4 cars
- Integral garage
- Beautifully maintained to a very high standard
- Beaches on the doorstep
- Quiet cul-de-sac
- New Guide Price £580,000-£600,000



Sharkham Drive

Brixham,

The property is situated on the popular Sharkham Village development approximately 1 mile from Brixham town centre which boasts an array of shops amenities and facilities as well as the picturesque Brixham harbour which itself is surrounded by a range of boutique shops, bars and restaurants. Both primary and secondary schooling are within 1/2 to 2/3 of a mile distant and it allows easy access to St Marys Beach which is no more than 1/3 of a mile away also giving access to the stunning South West coast path.

Absolute Sales & Lettings

Absolute Sales & Lettings, 36 Fore Street - TQ5 8DZ

01803 214214

brixham@movewithabsolute.co.uk

movewithabsolute.co.uk/



Ground Floor

Approx. 62.8 sq. metres (676.2 sq. feet)

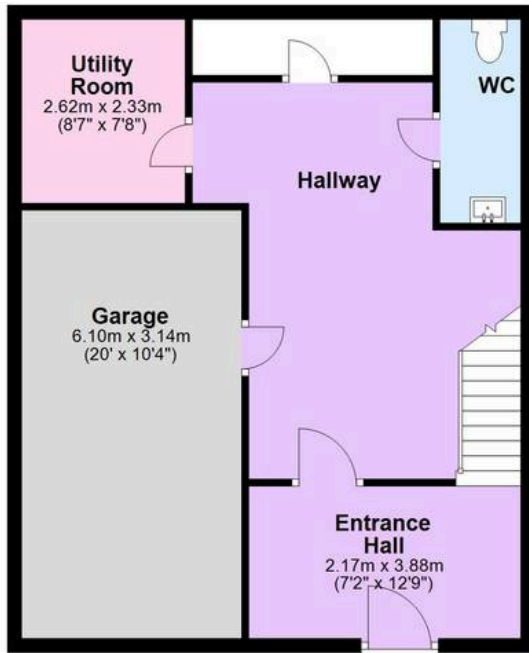

First Floor

Approx. 50.3 sq. metres (541.7 sq. feet)

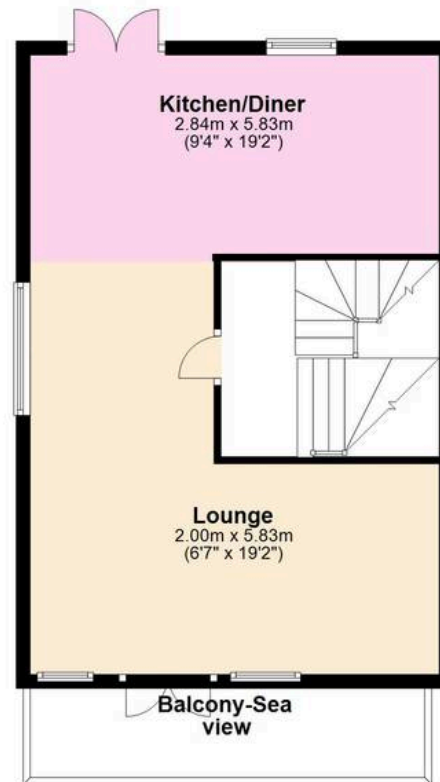

Second Floor

Approx. 58.7 sq. metres (632.3 sq. feet)

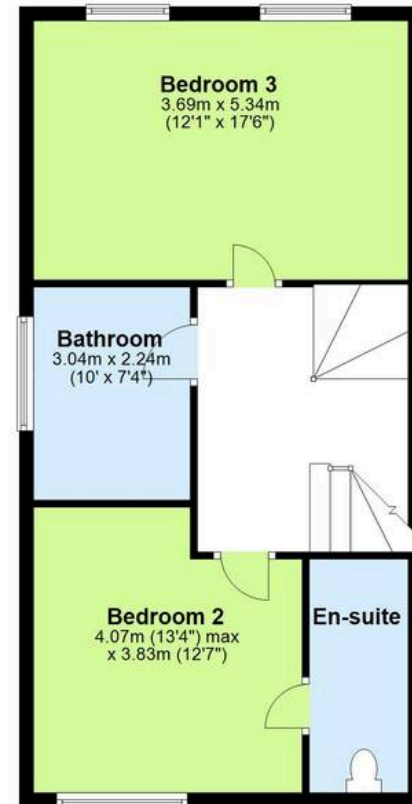

Third Floor

Approx. 59.0 sq. metres (635.3 sq. feet)

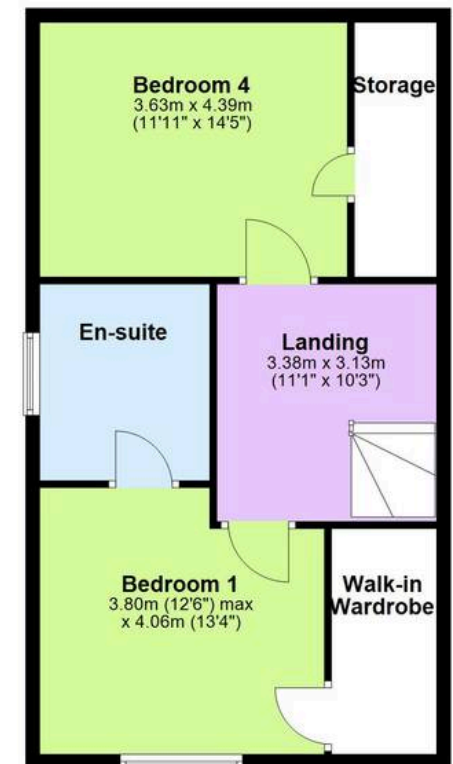

Total area: approx. 230.9 sq. metres (2485.6 sq. feet)