



19 Padacre Road, Torquay - TQ2 8PU

Guide Price **£300,000**

ABSOLUTE
SALES & LETTINGS





19 Padacre Road

Torquay, Torquay

Well-presented 2 bed semi detached bungalow in popular Watcombe Park, with driveway, garage, two double bedrooms and good sized rear garden

Council Tax band: C

Tenure: Freehold

EPC Energy Efficiency Rating: D

EPC Environmental Impact Rating:

- Well presented two bedroom semi detached bungalow
- Popular Watcombe Park residential area
- Quiet setting ideal for retirement buyers
- Sitting room with feature fireplace
- Kitchen/diner overlooking the rear garden
- Two well proportioned double bedrooms
- Modern Bathroom
- Gas central heating and uPVC double glazing
- Driveway parking and single garage
- Good sized terraced rear garden



19 Padacre Road

Torquay, Torquay

Padacre Road sits within Watcombe Park, a well regarded residential area of Torquay known for its quiet setting, established homes and strong appeal among downsizers and retirement buyers. The area offers a more relaxed pace while still being conveniently placed for local shops and everyday amenities. Nearby St Marychurch provides a useful range of independent shops, cafés, supermarkets, pharmacies and day to day services, while The Willows and Wren Retail Park are also within reach for larger shopping facilities, including Marks & Spencer, Sainsbury's, Boots and Next. Torquay Golf Club, Babbacombe Downs and the surrounding coastal walks are all accessible from this side of Torquay, with beaches, green spaces and local leisure facilities adding to the area's appeal. Bus routes connect the area with Torquay town centre, St Marychurch, Babbacombe and surrounding districts, while road links provide access towards the South Devon Highway, Newton Abbot, Exeter and beyond. For buyers wanting a quiet residential setting with amenities close by. Watcombe Park

Absolute Sales & Lettings

Absolute Sales & Lettings Ltd, 13 Ilsham Road - TQ1 2JG

01803 214214

torquay@movewithabsolute.co.uk

movewithabsolute.co.uk/



Ground Floor

Approx. 85.1 sq. metres (915.8 sq. feet)
(excluding Porch)

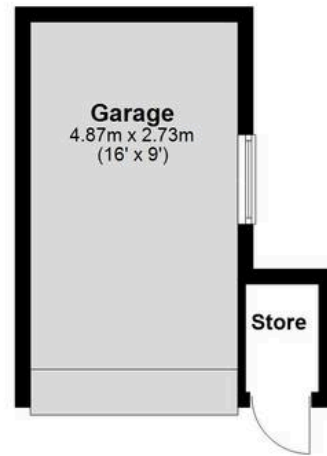

Total area: approx. 85.1 sq. metres (915.8 sq. feet)

