



Hunters Lodge
Manor Road
Sidcup
DA15 7JT

Leasehold

A well-presented one-bedroom, first-floor purpose-built flat, ideally located on a quiet residential road close to all local amenities, including shops, schools and bus routes, and within walking distance of Sidcup mainline railway station.

The property benefits from an entry phone system, double glazing and electric heating. The accommodation comprises a communal entrance with stairway to the first floor, private entrance hall, a bright living room with front-facing window, a fitted kitchen, good-sized bedroom with built-in wardrobe and a modern bathroom.

Externally, the property offers communal rear gardens and allocated underground parking space for one car.



Local Authority Bexley London Borough
Council
Council Tax Band C
EPC Rating C

Lease 113 years remaining
Service Charge £1,879 per annum
Ground Rent £200 per annum

Manor Road, Sidcup, DA15

Approximate Area = 507 sq ft / 47.1 sq m
For identification only - Not to scale

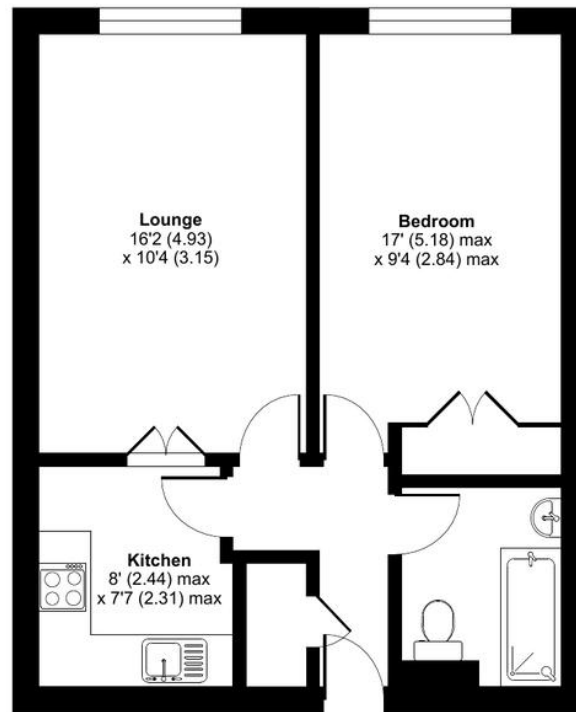

FIRST FLOOR



Drewery Property Consultants
128 Station Road
Sidcup
Kent
DA15 7AF

Contact
020 8269 6605
info@drewery.co.uk
www.drewery.co.uk

Agents Note: Whilst every care has been taken to prepare these particulars, they are for guidance purposes only. All measurements are approximate and are for general guidance purposes only and whilst every care has been taken to ensure their accuracy, they should not be relied upon and potential buyers/tenants are advised to recheck the measurements.