

Part Exchange  
Considered



7 Lorna Road, Cheadle Hulme, SK8 5BJ

SHRIGLEY ROSE & CO  
Bespoke Estate Agents



## 7 Lorna Road, Cheadle Hulme, SK8 5BJ

A rare opportunity to acquire a much-loved family home, beautifully maintained since 1968 and set within a truly stunning garden.

Owned by the same family since 1968, this beautifully maintained and light-filled home offers generous living space, a stunning rear garden, and exciting potential to extend (subject to the necessary permissions), with neighbouring homes having already extended to the rear and into the loft. This is a home that has been truly cherished over the years and offers a rare opportunity for the next owners to create their long-term family home.

The ground floor features three reception rooms, providing flexible and versatile living space to suit modern family life. The living room centres around an electric fire and enjoys an abundance of natural light, with French doors opening directly onto the patio and garden, creating a lovely connection between inside and out. A pocket sliding door connects the dining room and living room, which can be opened to create a more open plan layout when entertaining or for day-to-day family living. The kitchen is bright and well arranged, located next to a convenient downstairs W/C. Appliances include an AEG electric hob, with space for a fridge freezer, washing machine and dryer, which may be available by separate negotiation (the dryer may be taken).





## 7 Lorna Road, Cheadle Hulme, SK8 5BJ

Upstairs, the staircase features a stylish glass balustrade complemented by an oak handrail, adding a modern touch to the home. The first floor offers three well-proportioned bedrooms, a separate bathroom with walk-in shower, and a separate W/C.

The master bedroom benefits from fitted wardrobes and storage units over the bed, along with a bay window fitted with plantation shutters, creating a lovely focal point to the room.

Bedroom two enjoys attractive views over the rear garden and includes sliding fitted wardrobes.

Bedroom three, with fitted wardrobes and storage above the bed, overlooks the front and would make an ideal child's bedroom, nursery or home office.  
location.



### We Have Noticed:

- Great location, walking distance of Cheadle Hulme Village
- Scope to create your dream family home
- Incredible outside space





### Key Features:

- Much-loved family home owned since 1968
- Quiet location within walking distance of Cheadle Hulme Village and well regarded schools
- Three reception rooms offering flexible living space with French doors opening onto patio and garden
- Three well-proportioned bedrooms with fitted wardrobes
- Driveway providing parking for up to five cars
- Single garage and additional shed for storage
- Stunning, long rear garden with greenhouse and mature planting
- Potential to extend to the rear and into the loft (STPP)

Tenure: Leasehold

Council Tax Band: D

Possession: Vacant possession upon completion

Total Floor Area: 960 sqft

Viewing: Strictly appointment only through Shrigley Rose & Co

## Property Summary:

Outside, the property continues to impress. To the rear, there is a patio area directly outside the French doors, leading onto a particularly long and picturesque garden featuring a willow tree, well-stocked borders, a greenhouse, and a variety of established plants - a garden clearly cared for by a keen gardener over many years and now offering a peaceful and private setting to enjoy throughout the seasons. There is also a single garage (currently used for storage) with a manual door, and a shed located behind.

To the front, a long driveway, partly separated by manual gates, provides parking for up to five cars.

The home is situated on a quiet road within walking distance of Cheadle Hulme Village, well regarded schools including Lane End Primary School and Cheadle Hulme High School, along with excellent transport links and local amenities, making it an ideal long-term family home in a highly desirable





DID YOU KNOW...? YOU CAN PART EXCHANGE YOUR CURRENT HOME FOR THIS PROPERTY... HASSLE FREE.

**Ground Floor**  
562 sq.ft. (52.3 sq.m.) approx.

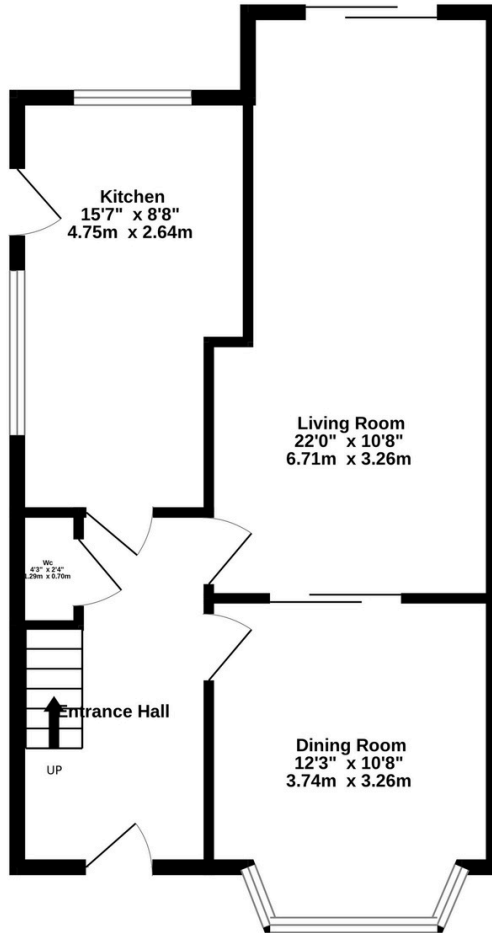

**1st Floor**  
398 sq.ft. (36.9 sq.m.) approx.

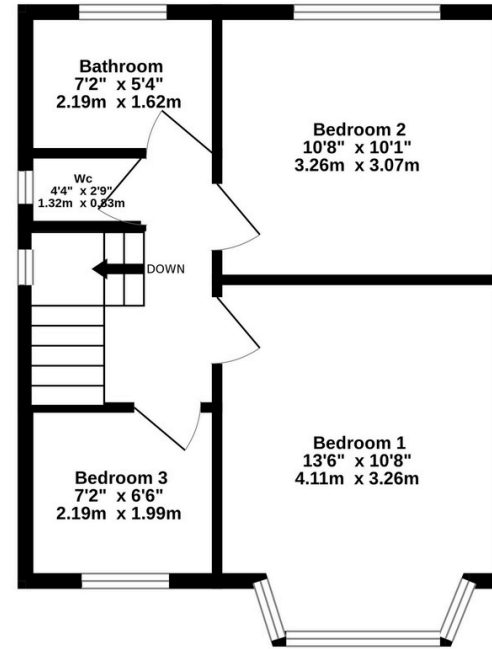

**TOTAL FLOOR AREA : 960 sq.ft. (89.2 sq.m.) approx.**

Whilst every attempt has been made to ensure the accuracy of the floorplan contained here, measurements of doors, windows, rooms and any other items are approximate and no responsibility is taken for any error, omission or mis-statement. This plan is for illustrative purposes only and should be used as such by any prospective purchaser. The services, systems and appliances shown have not been tested and no guarantee as to their operability or efficiency can be given.  
Made with Metropix ©2026



4 Ravenoak Road, Cheadle Hulme, SK8 7DL

Tel: 0161 425 7878

Email: [hello@shrigley-rose.co.uk](mailto:hello@shrigley-rose.co.uk)

[www.shrigley-rose.co.uk](http://www.shrigley-rose.co.uk)

All descriptions, images and marketing materials are provided for general guidance only and are intended to highlight the lifestyle and features a property may offer. They do not form part of any contract or warranty. Whilst we take care to ensure accuracy, neither Shrigley Rose & Co. nor the seller accepts responsibility for any inaccuracy that may be contained herein. Prospective purchasers should not rely on the details as statements of fact, and are strongly advised to verify all information through their own inspections, searches and enquiries, and to seek confirmation from their appointed conveyancer before proceeding with any purchase.